

LARGE SCALE PROJECTS & MASTERPLANS



ROTO ARCHITECTS MASTERPLAN PROJECTS

The range of projects RoTo Architects has worked on, have varied in scope size and complexity. The works in this portfolio, small or large always consider long term visioning in the context of varying shorter cycle forces. Social and cultural models interface financial and business modeling, eventually integrating into a greater hybridized whole. As the works are taking form, we embed principles and practices to afford adaptability, flexibility, performance, and endurance.

A long-term strategic plan establishes core principles and values, that regulate growth, set the rules of engagement, and inform overall behavior and operations for the life of a project of any size, complexity, or time horizon.

The depth of our knowledge and experience comes from two sources, 35 years of both professional and education-based practice. In teaching we invent and explore the potential of projects at every scale, buildings to sectors of cities, and then bring what we have learned into professional studio, to inform commissioned works as we execute and deliver the projects.

The commissioned works range from architecture and master planning, urban design, and conservation-based land planning on 100 to 5000 acres in Montana and Hawaii. The objectives are strategic consulting, repurposing properties, studies for highest and best use, beyond retail, incorporating informal learning systems and creative tools into everyday programs, and cultural restoration and resilience.

The following portfolio includes selected works we have done over the last 10 years.

FIRM PROFILE

RoTo Architects is an international practice, led by Michael Rotondi, FAIA, an internationally recognized teacher-practitioner. RoTo Architects is based in Los Angeles.

Since its' founding in 1991, RoTo Architects has worked with diverse groups and individuals, (Civic Leaders in the public and private sectors, American Indians, Tibetan Lamas, commercial developers, artistic directors, education communities, wildlife conservators, cultural curators, and many non-profit leaders) on a wide array of projects of varying scope, complexity, and resources. We have learned the value of working collaboratively and the benefit of listening with open minds, heightened curiosity, and a sense of great purpose. We also understand the necessity of sustaining the integrity of a clients' long term vision and core principles that guide us working with a sense of urgency in short cycle world. Also, with abundant optimism and advanced skill sets we've learned, that limited resources, aggressive schedules, and conflicting objectives can be a source of innovative thinking and lead to inventive outcomes.

Although we have many years of experience and have broad expertise, we try to approach each project with an resilient mind and fresh eyes knowing that each project has different parameters and constraints, based on their environmental, social, cultural, and market contexts. We've learned how to work efficiently and effectively at a pace that meets these aggressive schedules but in a way that allows us to anticipate the unexpected with beneficial outcomes.

Currently, we have a diverse portfolio of commissions we are working on, a new television production and broadcast facility in Los Angeles, a large aquatic center in Long Beach, CA, a 160-acre wildlife sanctuary for wolves in California, a self-sustaining research, retreat and conference center in Hawaii, a prototype couture store, a Buddhist Monastery and Temple in California, and an amusement park.

As a body of work, these projects exemplify a capacity to see to the center of any problem, work at any scale, and synthesize complex systems into a coherent and high performing whole. The Team Leader, Michael Rotondi brings trans-disciplinary interests and knowledge to every aspect of a project and filters it through the conceptual and practical lens of what it takes to realize a project. He has long-standing experience in both Enterprise and Academia, leading large teams with creative and technical knowledge and expertise, which was evident some years ago as the Director of Southern California Institute of Architecture (SCI-Arc) with its international faculty and student body.

RoTo Architects has a sister company, Rotolab, an innovation engine dedicated to addressing the epic challenges and major shifts facing current and near-future education and enterprise. RotoLabs' interests are real world projects situated at the nexus of architecture, neuroscience, games, and cooperative technologies.

PRINCIPAL **MICHAEL ROTONDI, FAIA**

RoTo Architects

IN PRACTICE

Michael Rotondi is an architect/educator, recognized internationally. He has practiced and taught for thirty-five years, and defines both as one activity. Teaching is the research part of the broader practice, where more experimental ideas, hypothetical projects, and techniques are tested. The professional studio RoTo Architects, Inc., is where these ideas are implemented in real time and at full scale. He has always been based in Los Angeles, co-founding 2 international practices, as a partner of Morphosis, (1975-1991) and currently, RoTo Architects (1991-present). His longtime work as a cross-disciplinary educator-practitioner is the basis for an open-minded approach that produces outcomes as unique as the variables that define the projects. Since its founding in 1991, RoTo Architects has designed a wide range of projects of varying type, scope and complexity. As a body of work it represents a expertise in solving any one of a kind as well as more conventional problems with precision, economy and invention. Mr. Rotondi has experience working with a diversity of forward thinking clients in a wide range of fields; education, culture production, civic and government leadership, entrepreneurs, conservationists, indigenous people, and spiritual teachers. The portfolio includes the following project type:

CONTEMPLATIVE - Spiritual Retreats, Temples, Monasteries
INSTITUTIONAL - Education, Black box Theaters, Health Care (Cancer Center, Dialysis)
ENVIRONMENTAL - Restoration-land planning, Animal Sanctuaries, Wildlife Center and Hospital
CULTURAL - Native American, Hawaiian, and Tibetan
RECREATION/SPORTS - Aquatic center, Gymnasium, Sports Complex, YMCA
COMMERCIAL - Restaurant, Retail, Hospitality, Entertainment, Re-purposed Industrial, Shopping Centers
RESIDENTIAL - Single Family, Extended Family, Co-Housing, Multi-Unit, Meditation Hermitages
CIVIC - Civic Center, Public Broadcasting, Public Plaza

IN EDUCATION

Prof. Rotondi is an educator with an international standing. He was a co-founder of SCI-Arc in 1972 along with 50 other colleagues. In his various leadership roles over the forty years since its founding, he has participated in creating and growing a school that is recognized internationally among the best. He succeeded Founding Director Ray Kappe as the second Director after creating and directing the Graduate Program. His charge was to reinvent the school after the first fifteen years, providing leadership in formulating an educational vision that would give the Institute, the faculty, and the students a platform to participate in defining the discussion-debate emerging within the Discipline internationally. He is currently a Distinguished Faculty and Trustee Emeritus at SCI-Arc and Professor of Architecture at Arizona State University (ASU). Prof. Rotondi has taught and lectured throughout the world for many years on Architecture, Education, and Creativity. He has been recognized and awarded many times for design practice and teaching. Among the awards are, Progressive Architecture P/A, AIA Awards, American Academy of Arts and Letters for Architecture, AIA College of Fellows, LA/AIA Gold Medal, AIA/SFV Lifetime Award, and in 2013, he was voted by his peers, among the "30 Most Admired Design Teachers in America."

TABLE OF CONTENTS

- 01 **Hi-Tech**
- 02 **World Trade**
- 03 **Sports & Wellness**
- 04 **Entertainment**
- 05 **Retail & Hospitality**
- 06 **Academia**
- 07 **Clean Tech**
- 08 **Ordering Principles**

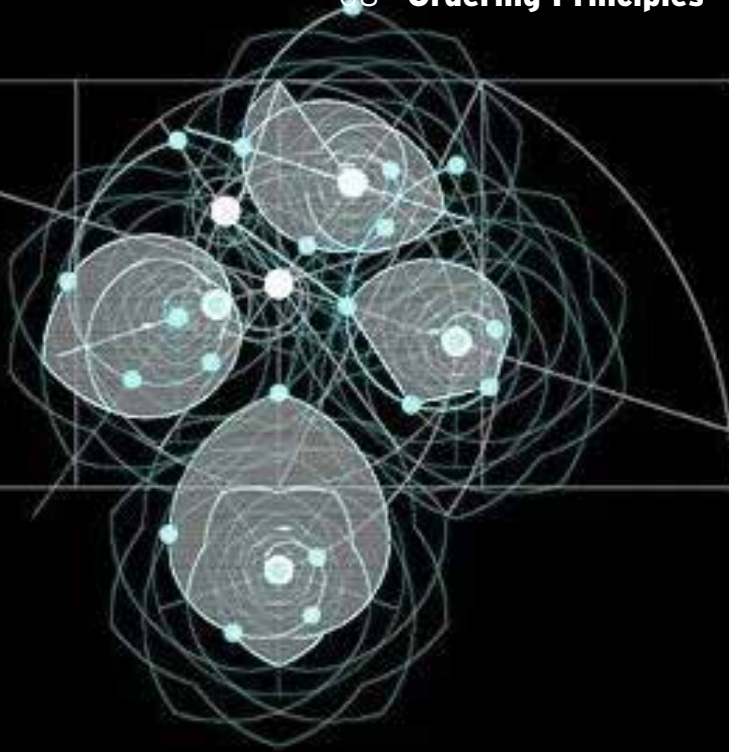

01 AFFINITY PARK

LOS ANGELES, CALIFORNIA

A theme park for RCV for land and air will be a place for entertainment, workshops for learning the technology and a testing site for research.

Affinity Park is a destination where hobbyists and competitors can operate radio-controlled vehicles and drones. They can also come here to learn how to operate, build, and innovate on the technology. This park can accommodate fixed wing and quad-copter type aircraft, and every type of on and off-road vehicles as well as watercraft, for beginners, intermediate, and experts. AP also operates as a co-working space, incubator and research park for drone related start-ups and research laboratories. Affinity Park includes several gamerspaces distributed though out, designed to act as a point of convergence between hobbyists and researchers to foster dialogue, informal education ideation, innovation, in support of entrepreneurs.

RELEVANCE Entertainment, innovative technology, sport, education, product development and sales

STATUS Conceptual Design

SIZE 20 - 40 Acres

CLIENT Affinity Park Inc.



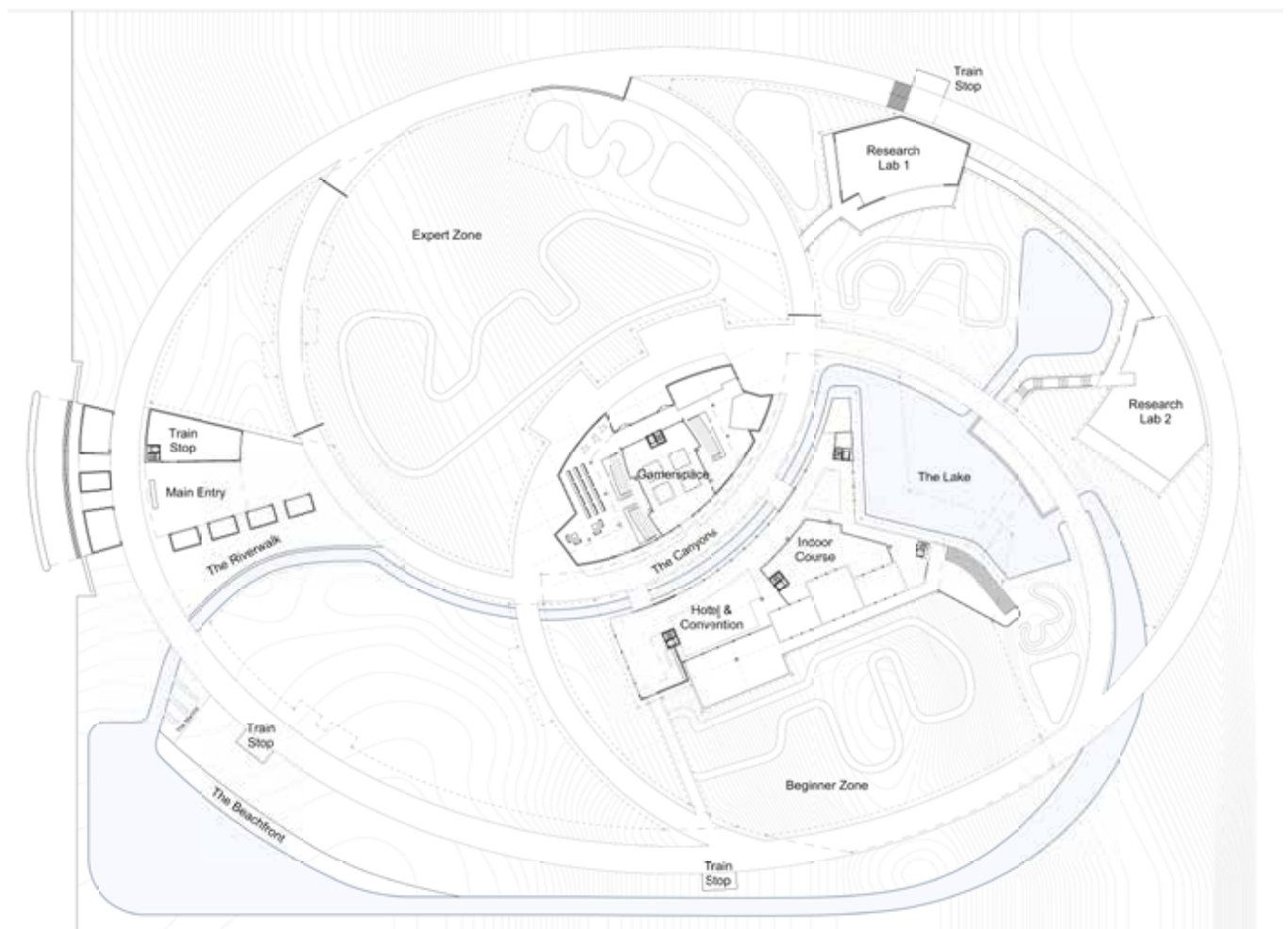

02 CHANNEL 35 TELEVISION STUDIO

LOS ANGELES, CALIFORNIA

A new TV Production and Broadcast facility for the City of Los Angeles within its' historic core.

The Channel 35 Television Studio project is located in the historic El Pueblo district in downtown Los Angeles; the historic center of the city. This unique project inserts a 21st century digital media program into a series of 19th century buildings. Channel 35 will re-inhabit the City of Los Angeles's first theater (Merced Theater, an 1870 National Historic Registered building) with executive offices and facilities for live TV recording, production, and broadcast distribution. Also, on the ground floor there is a public live audience studio/theater for the use of the surrounding El Pueblo community. The challenges of placing a state-of-the-art digital facility TV Station in buildings constructed in the late 19th C., were many. The new facility will have a new public entry and plaza, a small 'Zocalo' for communal public events, marked with landmark elevator tower.

RELEVANCE/ ROLE OF FIRM

Community use, public venues, media & broadcasting technology, historic structure, adaptive re-use. Programming, architectural design, interior design, consultant coordination, materials research, construction documents and administration

STATUS

Construction to Begin in 2020

SIZE

25,000 SF

CLIENT

City of Los Angeles



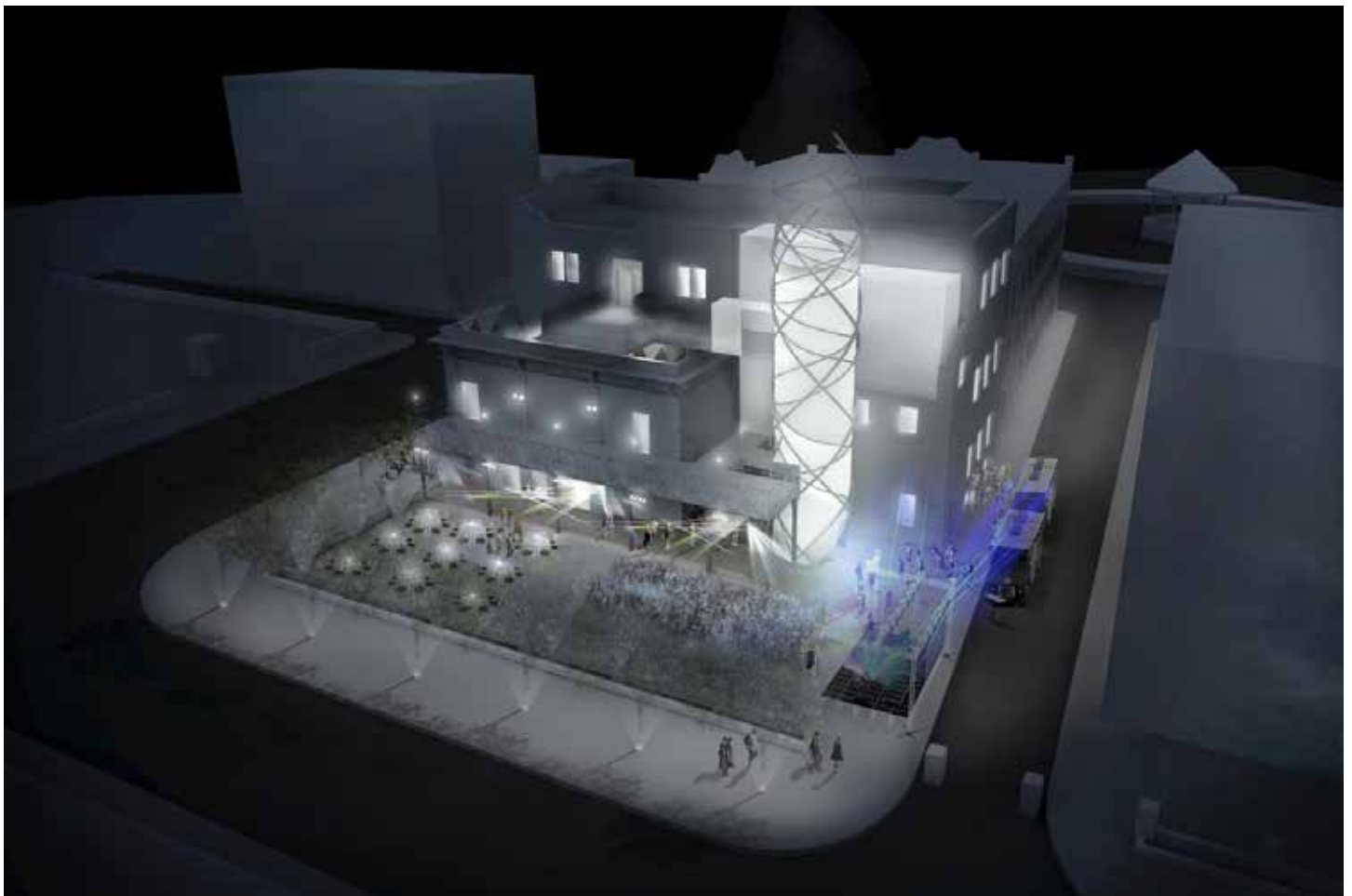
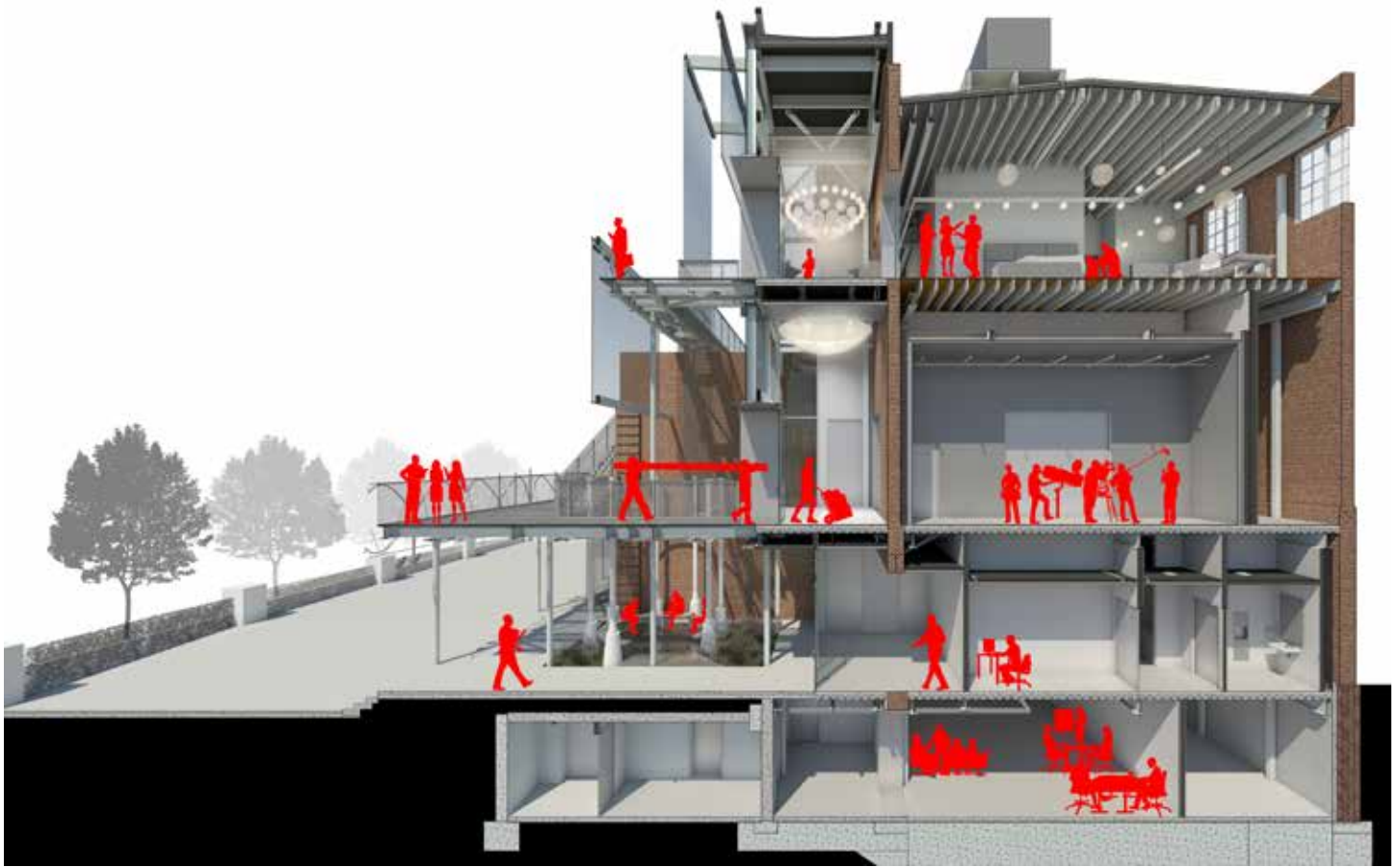

03

LUX STUDIOS

CULVER CITY, CALIFORNIA

The new studio campus for LuxCore will provide for feature film, television, multi-media, games, and new media productions.

Additional facilities include, rooftop outdoor theater and bungalows, screening rooms, post-production offices, two restaurants, a boutique hotel, and a new media creation school.

The fifteen acres of site will have eight soundstages to accommodate both small and large production, with support spaces, and 4 insert stages. There will be a total of 825,000 square feet of development with 1,700 parking spaces.

RELEVANCE	Media & broadcasting, technology, master-planning, adaptive re-use, entertainment industry.
STATUS	CONCEPT
SIZE	825,000 SF Building
CLIENT	LuxCore





04 WAREHOUSE C

NAGASAKI, JAPAN

A private warehouse as long as the wharf, processing the dry goods distributed into Nagasaki with a public rooftop promenade accessible to the public.

It is 200 meters long, 25 meters wide and an average of 22 meters high, dimensions comparable to a tanker. It is organized in 3 essential parts: a two level warehouse on the bottom, a public garden on its roof and a 20 meters diameter spherical exhibition hall. The roof scape, a new elevated ground floor plane, provides a public link between the new ferry terminal and retail elements on the new wharf and the center of the city. The garden is a present-day version of the traditional “dry” gardens of Tokyo, and serves as the main public space on the wharf.

RELEVANCE/ ROLE OF FIRM

Commercial architectural design, international trade, shipping, public space, master-planning, interior design, parking structure, consultant coordination, materials research, construction documents and administration

SIZE

125,000 SF

CLIENT

Governor Isamu Takada





05 SHARJAH CHINATOWN

SHARJAH, UNITED ARAB EMIRATES

New town for a total population of 150,000 people, anticipated to be predominantly Chinese residents emigrating to Sharjah, UAE. The new satellite city will include everything necessary to grow and sustain a new sub-cultural community in a foreign country. Tourism will be a major part of the economic system as will electronics manufacturing, trading, and distribution of Chinese products. This intends to become a major nexus for Chinese middle eastern trade for this region.

Historically, principles of feng shui have been the basis for organizing new settlements of any size. This is a traditional belief and practice. They are the main attractor streets with most of the civic life anchored here. People, cars, trams, and monorail move through these long parkways filled with civic and there are two axis running perpendicular to each other bisecting the city.

RELEVANCE	Nation-building, tourism, international trade & distribution, multi-cultural community.
STATUS	Concept
SIZE	Urban Scheme
CLIENT	Confidential



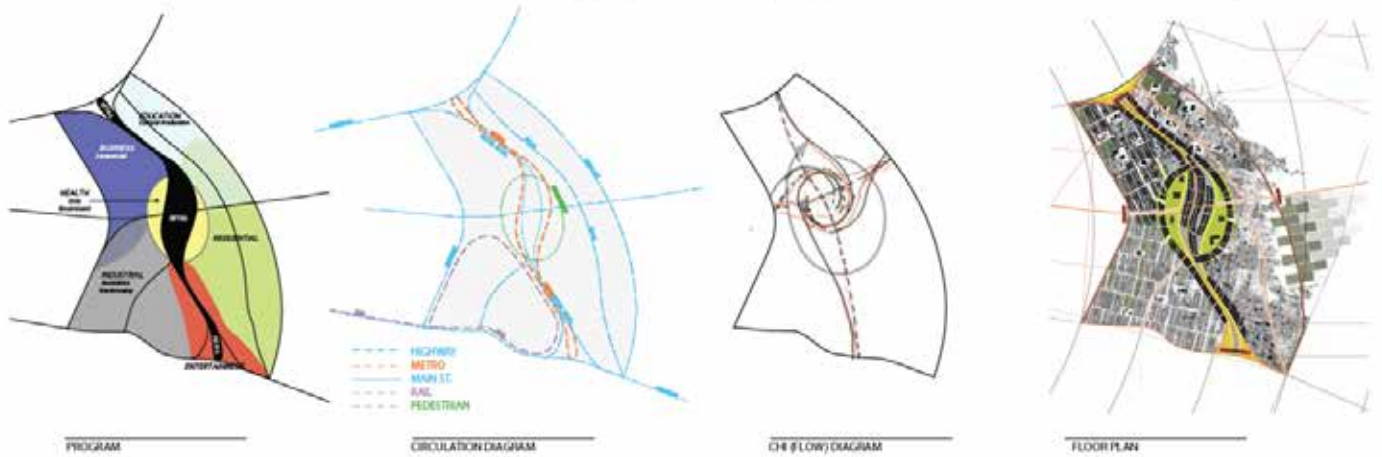
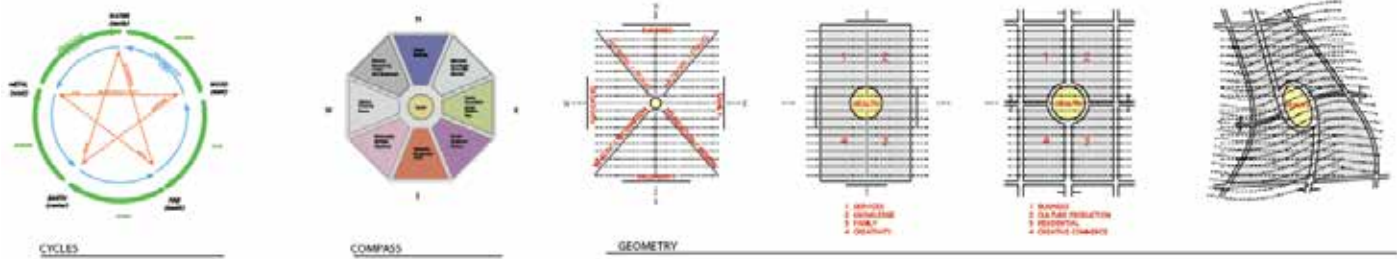

CHINATOWN, SHARJAH / UAE CONCEPT

Progressive Consultants (Pty) Ltd
 * o t o



06 SHAOXING RIVER COMPLEX AND GARDENS

SHAOXING, CHINA

A site bifurcated by a highway, and adjacent to a rail line and canal. On one side is commercial retail space with hotel and offices above, including co-working offices for this generation of emerging entrepreneurs. A full height atrium connects four towers creating informal work-meeting places. The base links to a new parkland across the highway via a tunnel, and to the canal with the addition of a boardwalk and boat dock.

RELEVANCE/ ROLE OF FIRM	Urban design, master planning, architectural design, interior design, consultant coordination, materials research, construction documents and administration
PROGRAM	Multi-use commercial retail, hotel, offices, pavilion, terrace, underground parking, park
STATUS	Concept
SIZE	7 Acre site; 2.3 Acre Building plus Parking
CLIENT	Shanghai Investment Group





07

BELMONT BEACH AQUATIC CENTER
LONG BEACH, CALIFORNIA

A facility designed for recreational and competitive aquatics and an anchor for communal family life.

The location for this Natatorium is an iconic site where the city meets the sea. A significant challenge has been at the clients’ request, to create a series of indoor-outdoor spaces filled with daylight. We were asked to revitalize and enhance communal life with an urban public space surrounding the new facility and fronting the beach, to honor aquatics, beach life, and sailing. The client also requested a memorable iconic experience and Architecture for both competitive aquatic sports and for community recreation. The indoor pools and support facilities will be enclosed with a lightweight and long-span structure enclosed with ETFE, a polymer pneumatic skin that can vary from transparent to opaque. controlling daylight and heat gain.

RELEVANCE/ ROLE OF FIRM	Public sports-recreation facility promoting community and healthy lifestyle, complex technical infrastructure, diverse simultaneous mixed-use, high aspirations with public funding. Programming, master planning, site planning, architecture, community presentations
STATUS	Construction to begin in 2022
SIZE	120,000 SF Building, 250,000 SF Site
CLIENT	City of Long Beach, Tidelands





08 YMCA HOLLYWOOD PARK

HOLLYWOOD, CALIFORNIA

YMCA Hollywood Park and Sports Center and Parking Structure is a private and public partnership.

This multi-purpose complex will serve the City, private landowners, and the YMCA. The Y will expand its programs and play places to attract a wider demographic while providing a park for the neighborhood and commercial facilities to earn income. In partnership with the city and adjacent property owners, the plan is to build a 400 car parking structure (4 levels) with a rooftop park for active sports, a teen and senior center, restaurant, and a sports research laboratory where athletes, scientists, engineers and designers converge to develop the key performance insights that improve health practices and athletic performance. Two buildings bookend the structure and park/athletic fields and connect the street to the upper field.

RELEVANCE/ ROLE OF FIRM

Multi-activity communal facilities, sports, classrooms, sports and recreation fields, community building, wellness, technology. Master planning, architectural design, interior design, consultant coordination, materials research, construction documents and administration

STATUS

Concept

SIZE

800,000 SF Building plus Parking

CLIENT

YMCA & Hollywood Park LTD





09 MIRACLE MANOR RETREAT AND SPA

PALM SPRINGS, CALIFORNIA

A retirement and independent living facility with 27 guestrooms, spa, and communal spaces.

Phase 1 - completed - A restored and upgraded 1950s era spa motel, with 8 guestrooms, main house and support facilities, sits atop a deep hot water aquifer in Desert Hot Springs, California, overlooking the Coachella Valley. Phase 2 - in design development - On adjacent properties, Miracle Manor will add 25 guest rooms, an owners' duplex, 2 additional mineral pools, and a meeting-dining room for guests serviced by a commercial kitchen. The original 6 guest rooms will be converted into a full-service spa with treatment rooms, communal spaces and administration. It will become a midsize exclusive retirement facility for independent and assisted living.

RELEVANCE/ ROLE OF FIRM	Hospitality, spa, wellness retreat, boutique B&B, Master planning, programming, architectural design, interior design, consultant coordination, materials research, construction documents and administration
STATUS	Design Development
SIZE	17,000 SF Building on 2 Acres
CLIENT	Michael Rotondi & April Greiman

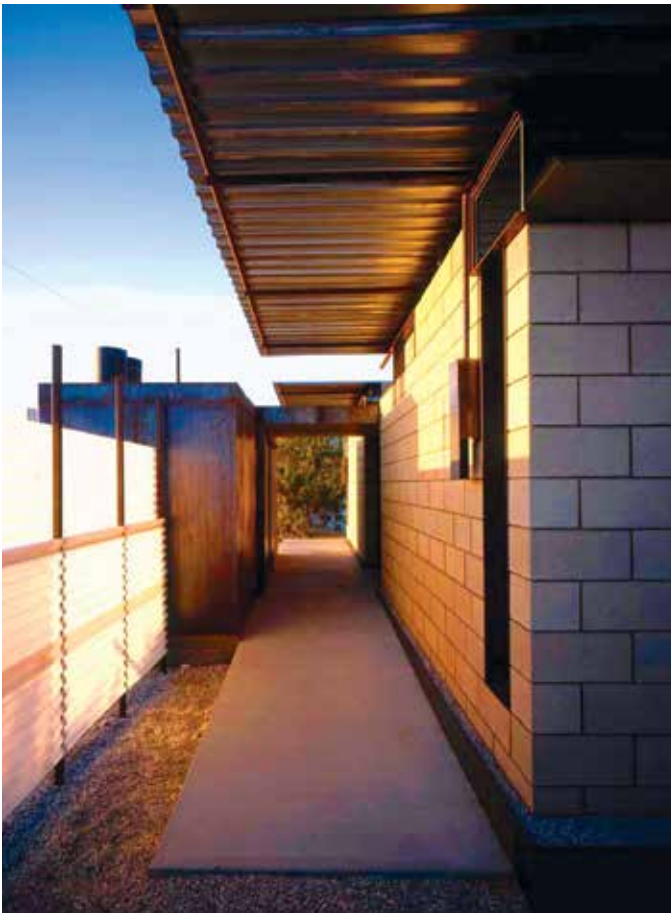

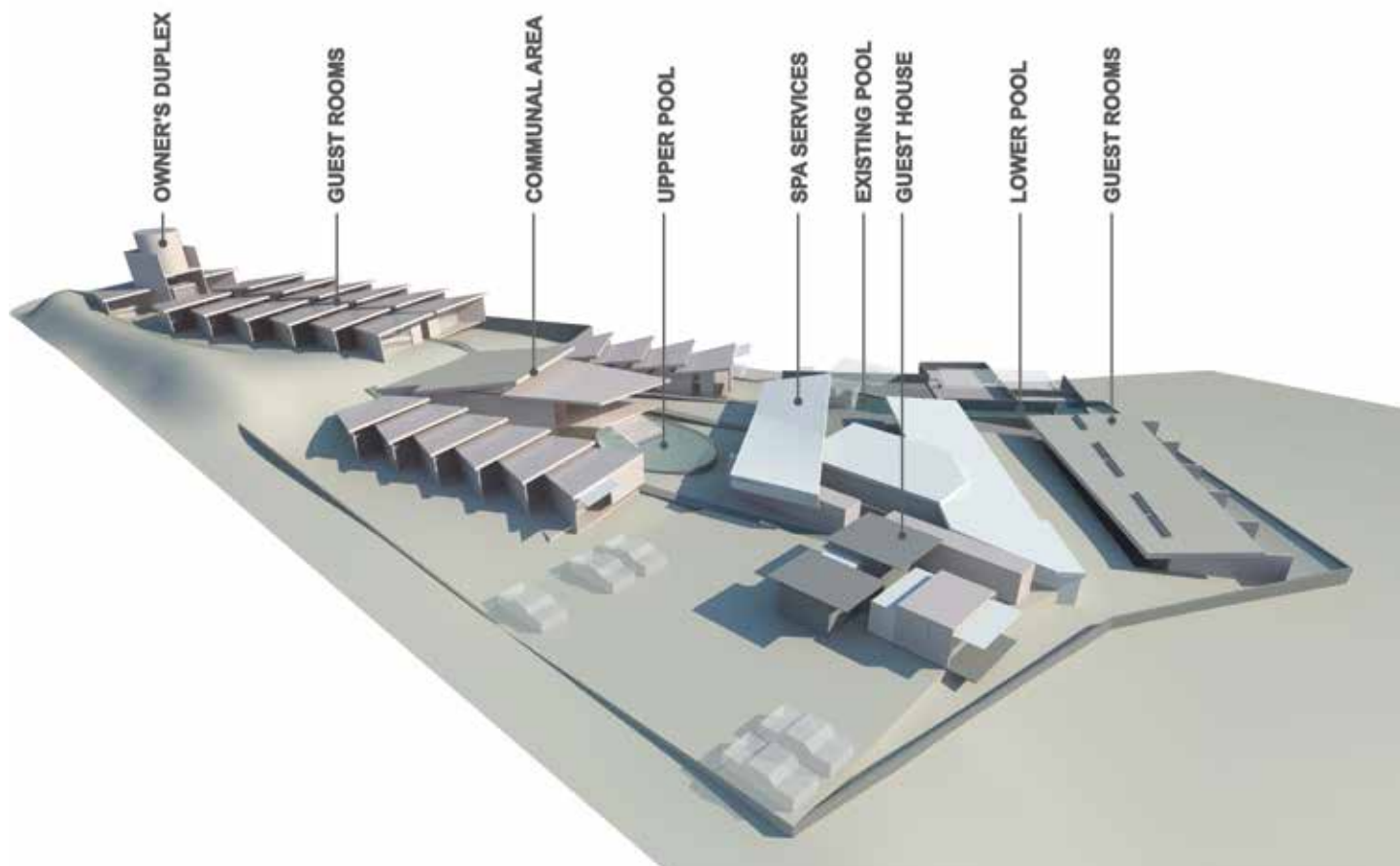

10

PD(X) PORTLAND EXPERIMENTAL DISTRICT

PORTLAND, OREGON

A new city district devoted to innovation in the creative arts, PD(X) was designed to be a modular, interim use program, occupying the urban interstitial spaces prior to redevelopment.

This design was shortlisted in a competition to redesign the area of downtown Portland immediately adjacent to the Keller Music Hall and containing the Halprin Sequence, a series of parks that connect different areas of this city.

Our design repurposed parking garages, rooftops, and unused urban space to create a district for innovation specifically focused on the creative arts and media.

RELEVANCE/ ROLE OF FIRM	Entertainment destination, multi-media & immersive experiences, performing arts, community building, concert area. Urban Design, Masterplanning, Architectural Design, Technological Design, Market Analysis, Narrative Development, Worldbuilding
STATUS	Concept
SIZE	Urban Scheme
CLIENT	Keller Music Hall Competition





11 TAIT RANCH

Tait Ranch, conceived and operated by S.E.A., will be used as a camp, conference center, leadership institute, park, farm, cafe, market, research center, and school.

Land as varied and unique as Tait Ranch has many natural assets, most significantly its' location, natural terrain, and water. The objective of an environmental and land use planning study parallel to a concept design proposal will be to identify these assets and propose ways to unpack their intrinsic value for the long and short-term benefit of SEA, the community it serves, and neighbors in Frazier Park.

The S.E.A's objective with this unique development is to construct intertwined educational, communal, and business models that are integrated into a generative, self-sustaining revenue streams. The programs proposed for the site serve SEA's mission, including project-based formal and informal learning that can lead to micro-degrees and certificates, and incubate small businesses that produce potential revenue streams to re-invest into the Ranch.

RELEVANCE/
ROLE OF FIRM

Master-planning, environmental and land-use planning, community hub & resource, education, multi-use space, social responsibility

STATUS Concept

SIZE 325 acre

CLIENT Soledad Enrichment Action

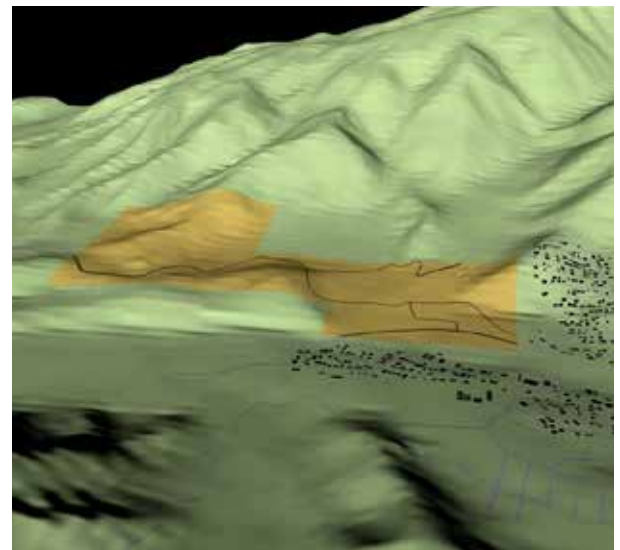
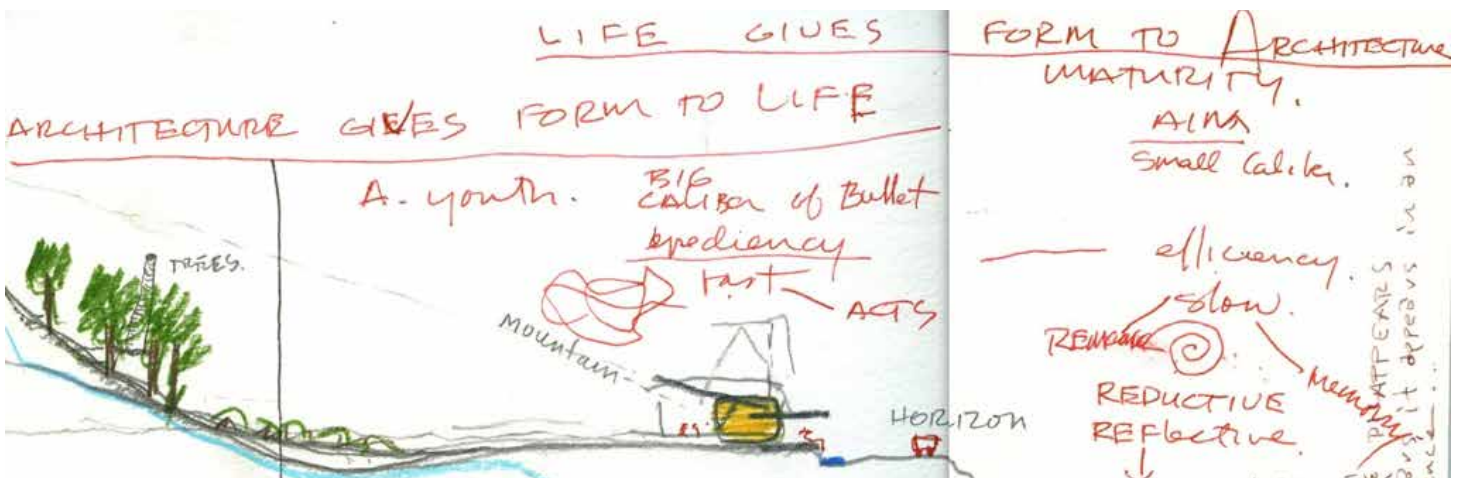

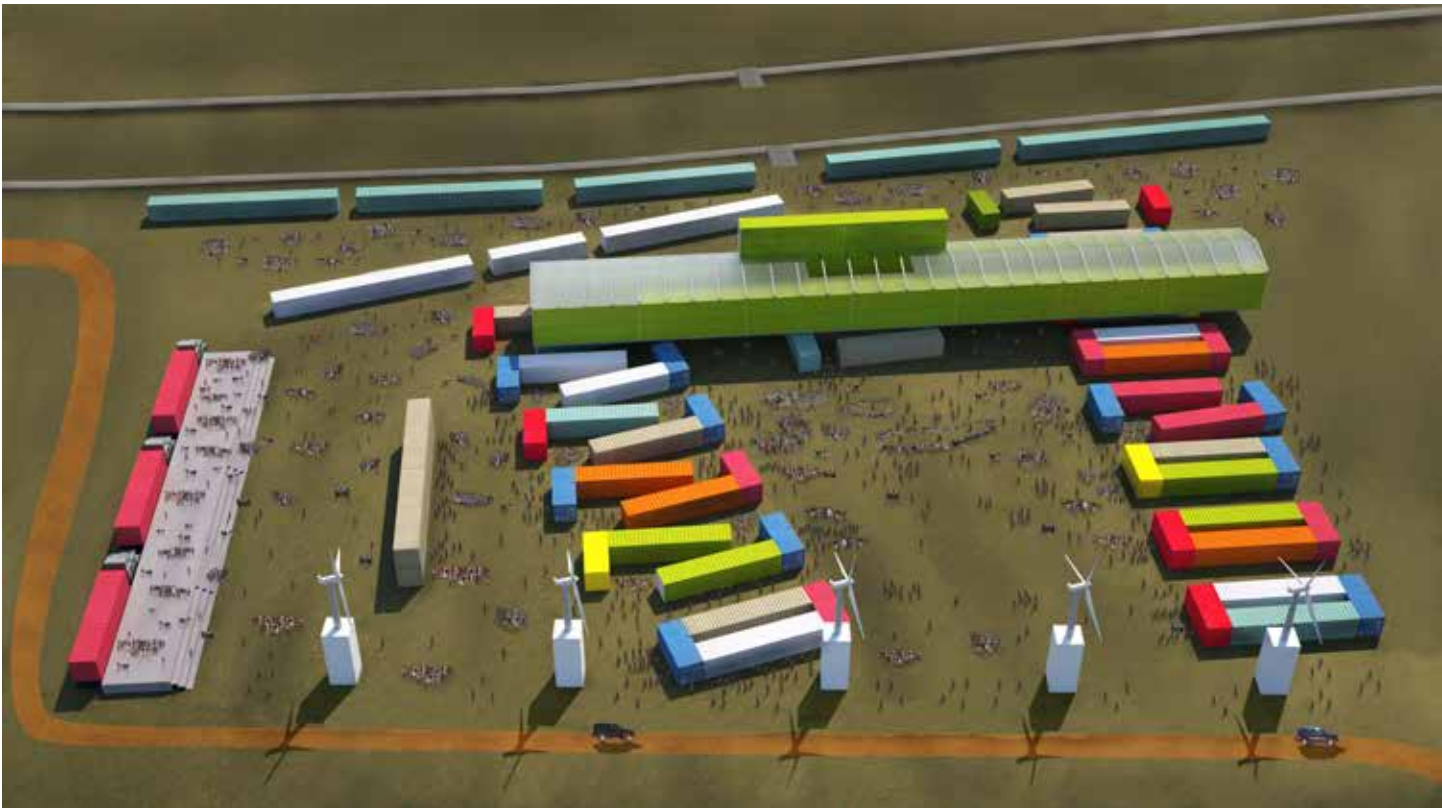

12 UCSD LA JOLLA PLAYHOUSE

SAN DIEGO, CALIFORNIA

Play Development and Educational Center for the LJP and UCSD Dept of Theatre and Dance.

RoTo Architects worked with the renowned La Jolla Playhouse and University of California San Diego (UCSD) in a partnership, planned and built the Play Development and Educational Center for the La Jolla Playhouse and UCSD Department of Theatre and Dance. The project consists of a flexible "Black Box" theatre for an audience of 450, a lab theatre, two large classroom/rehearsal spaces, technical support, set production, warehouse spaces, restaurant, creative studio, and administrative offices to provide a permanent artistic and administrative home for the Playhouse. This facility is an experimental laboratory with performance spaces for artists, educators and the public. It is a state-of-the-art facility for creating and producing one of a kind plays and large theater events headed for Broadway. The campus planning goal was to incorporate these new buildings into the Performing Arts district to effect a coherent identity, and create coherent public places to unify the three theaters in the district.

RELEVANCE/ ROLE OF FIRM

Public-private partnership, flexible theater, teaching and performance spaces, private use and public access. Programming, architectural design, interior design, consultant coordination, materials research, construction documents and administration

STATUS

Completed

SIZE

43,000 SF

CLIENT

University of California, San Diego

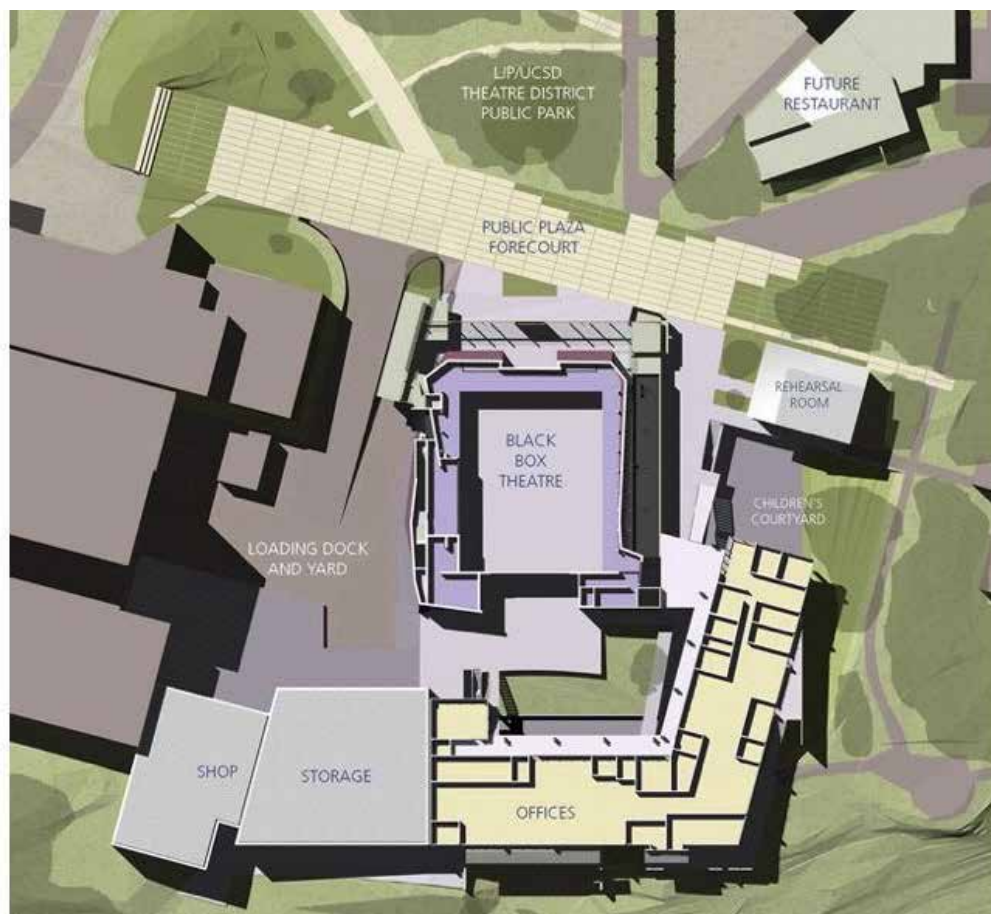



13 MADAME TUSSAUDS MUSEUM

HOLLYWOOD, CALIFORNIA

A museum and interactive attraction at the epicenter of tourism in LA with a multilevel public space.

Located in the heart of Hollywood on the famed strip of Hollywood Boulevard adjacent to the Chinese Theater, this museum and interactive attraction exhibits historical and contemporary celebrities as full size 'wax portraits'. Designed to accommodate one million visitors a year it is situated adjacent to the Dolby Theater (home of the Academy Awards) at the epicenter of tourism in Los Angeles, with 5 million visitors a year. Public space shaped by the new building can accommodate hundreds at a time and increase their dwell time from minutes to hours. This iconic building and symbol strengthens the urban public space on Hollywood Boulevard creating a public square for crowds to gather while going to the movies, shopping, dining, and walking.

RELEVANCE/
ROLE OF FIRM International attraction, museum, retail, parking structure, master planning, architectural design, interior design, consultant coordination, materials research, construction documents and administration

STATUS Completed

SIZE 90,000 SF Building plus Parking

CLIENT Philip Baker, Madame Tussauds, Hollywood Orange, LLC





RETAIL & HOSPITALITY

14 IBN BATTUTA MALL DUBAI, UNITED ARAB EMIRATES

The radical change is visual themes transformed into civic programmatic themes. Its uses will be modeled on a City Center with a richly detailed and full program of social and commercial activities bracketed by arts, culture, and religious (mosques, gardens) with a central pivotal activity being education and research. The entire new area will be networked with pedestrians, cars, and public transport, which connect to the new train station to the east of the complex. Because of the volume of people anticipated and to reduce the number of vehicles to the site, this network is comprehensive and easily accessible.

RELEVANCE	Specialty retail, upscale dining, multi-use, master-planning, community hub.
STATUS	Concept
SIZE	Existing 1M SF, Additional 3M SF
CLIENT	IBN Battuta Center, Nakheel Development

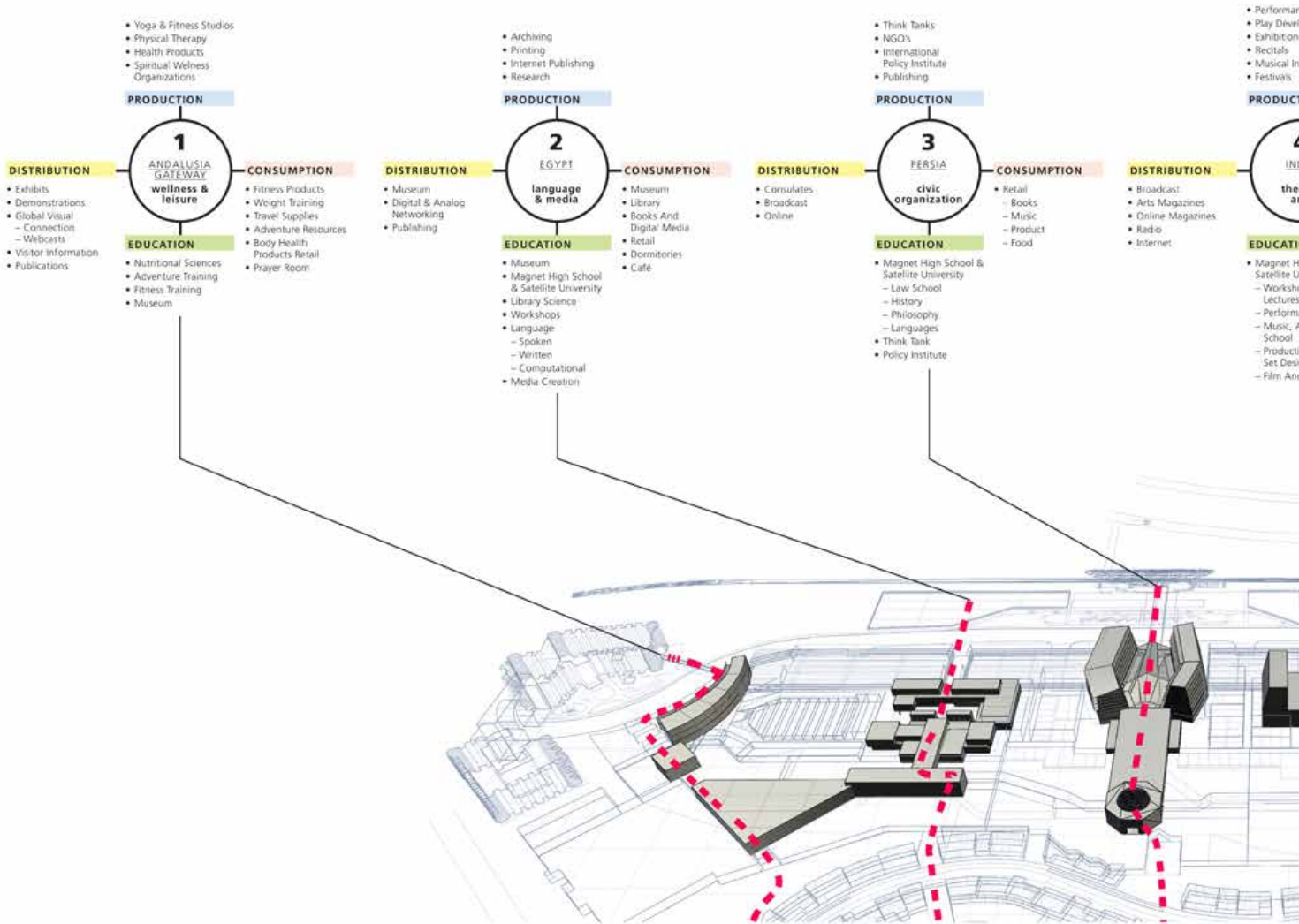

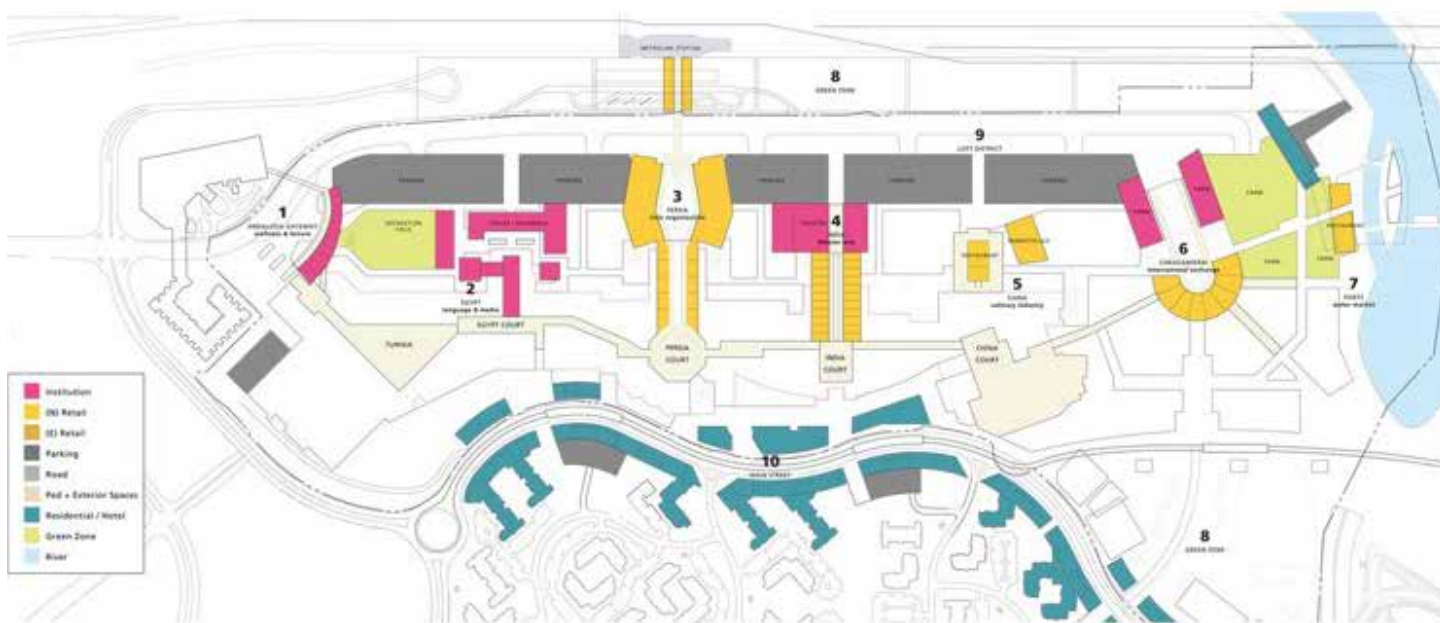

ce
omment
struments
ON
4
DIA
ater
ts
ON
ON
High School &
iversity
ops, Classes,
ance Art
rt, Theater
on/Stage
gn
Television

- Ceramics
- Graphics/Design
- Vegetable & Herb Gardens
- Bakeries
- Commodities Exchange
- Sanitation

PRODUCTION

5 CHINA

culinary industry

- DISTRIBUTION**
- Demonstrations
 - TV Broadcast
 - Wholesale
 - Kitchen & Restaurant Supplies
 - Catering & Delivery
 - Food Packing
 - Food Product Vendors

- CONSUMPTION**
- Food Court
 - Fast Dining
 - Fine Dining
 - Consumer Cooking Supplies
 - Gourmet Market
 - Artisanal Food Shops
 - Cookbook Store
 - Convenience Takeout

- EDUCATION**
- Magnet High School & Satellite University
 - International Trade, Business, Finance
 - Hospitality, Design And Management
 - Craft Workshops
 - Design Education & Workshops

- Commodities Trading
- Light Manufacturing
- Paid Programming
- Telemarketing

PRODUCTION

6 CARAVANSERAI

international exchange

- DISTRIBUTION**
- Shipping/Receiving
 - Warehousing
 - Wholesale Distribution & Marketing

- CONSUMPTION**
- Marketplace
 - Trade Shows
 - product - fashion
 - Retail
 - RESTAURANTS
 - Hostel/Hotel
 - CAFES

- EDUCATION**
- Magnet High School & Satellite University
 - International Trade, Business, Finance
 - Hospitality, Design And Management
 - Craft Workshops
 - Design Education & Workshops

- Vertical Farms
- Hydro Farm

PRODUCTION

7 PORTS

water market

- DISTRIBUTION**
- Depot
 - Water Taxi
 - Water Markets (Boats)
 - Restaurant Supply

- CONSUMPTION**
- Retail
 - Local/International Fresh Foods
 - Prepared Foods
 - Kitchen Ware
 - Cafe
 - Restaurants
 - Farmer's Market
 - Local Farm

- EDUCATION**
- Magnet High School & Satellite University
 - Botany
 - Agribusiness
 - Nutrition, Health-Wellness
 - Cooking
 - Broadcast

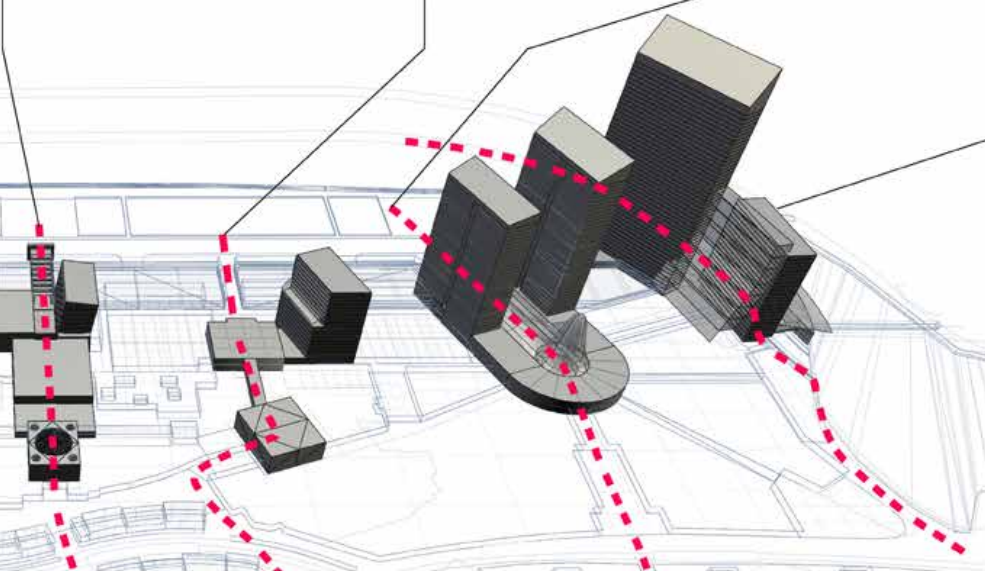

15 NEWPARK CENTER

NEWARK, CALIFORNIA

This proposal is to create a microcosm of a much denser city, in anticipation of the increased density around it. It will be integrated, porous and an attractor with a longer investment horizon to facilitate flexible growth markets. The primary retail will be similar to a year round consumer electronics and digital media entertainment exposition.

Newpark Mall, built in 1972, was once a thriving shopping center. There were no competitors. Now, within 5 miles, there are 6 malls, all newer. Newpark is essentially dead. Newpark has the potential of being the first civic center, with a civic scaled gathering space in Silicon Valley, it will be the geographical epicenter. It proposes to be a great social attractor with its 1.5 mile 'ring park,' piazza San Siliconé, and a full set of activities and uses: government, civic, commercial, residential, and recreational. It will be transformed in four phases, beginning with the parks, which will be used for recreation and environmental bio-remediation.

RELEVANCE Retail, master-planning, community hub & resource, multi-use space, regional destination, social responsibility.

STATUS Concept

SIZE 800,000 SF

CLIENT Broodfield Properties

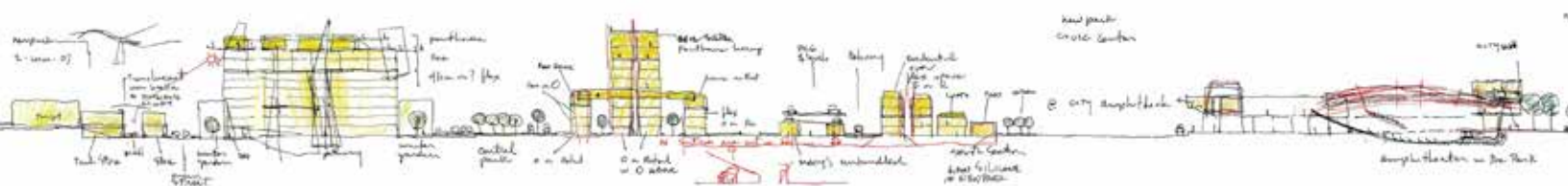

16 SINTE GLESKA UNIVERSITY
ROSEBUD SIOUX, SOUTH DAKOTA

Sinte Gleska University, the oldest tribal university in the Americas, was founded fifty years ago in Rosebud, South Dakota, by the Sicangu Band of the Lakota Nation. RoTo worked with Tribal members to develop a long term strategic and master plan for an entirely new campus on a prairie adjacent to a lake. New infrastructure and multiple buildings were planned and three were built. The Elders asked us to listen to their stories as we designed the land plan, and the architecture, metaphorically instrumental in teaching cosmology, spiritual and physical geography, energy harvesting, and construction.

RELEVANCE/ ROLE OF FIRM	Cultural resilience, Education, Economic development, education programming, creation of an education village based on their cultural traditions and collective practice, design of class rooms, laboratories for STEM education, media facilities for distance learning, multiuse facilities for teaching, learning, and administering education, public access performance spaces. Programming, architectural design, master planning, project mgt.
STATUS	Complete
SIZE	80,000 SF for 3 buildings on a 50 Acres
CLIENT	Sinte Gleska University Lionel Bordeaux, President Rita Means, Chair BOD Lannan Foundation-Patrick Lannan, President

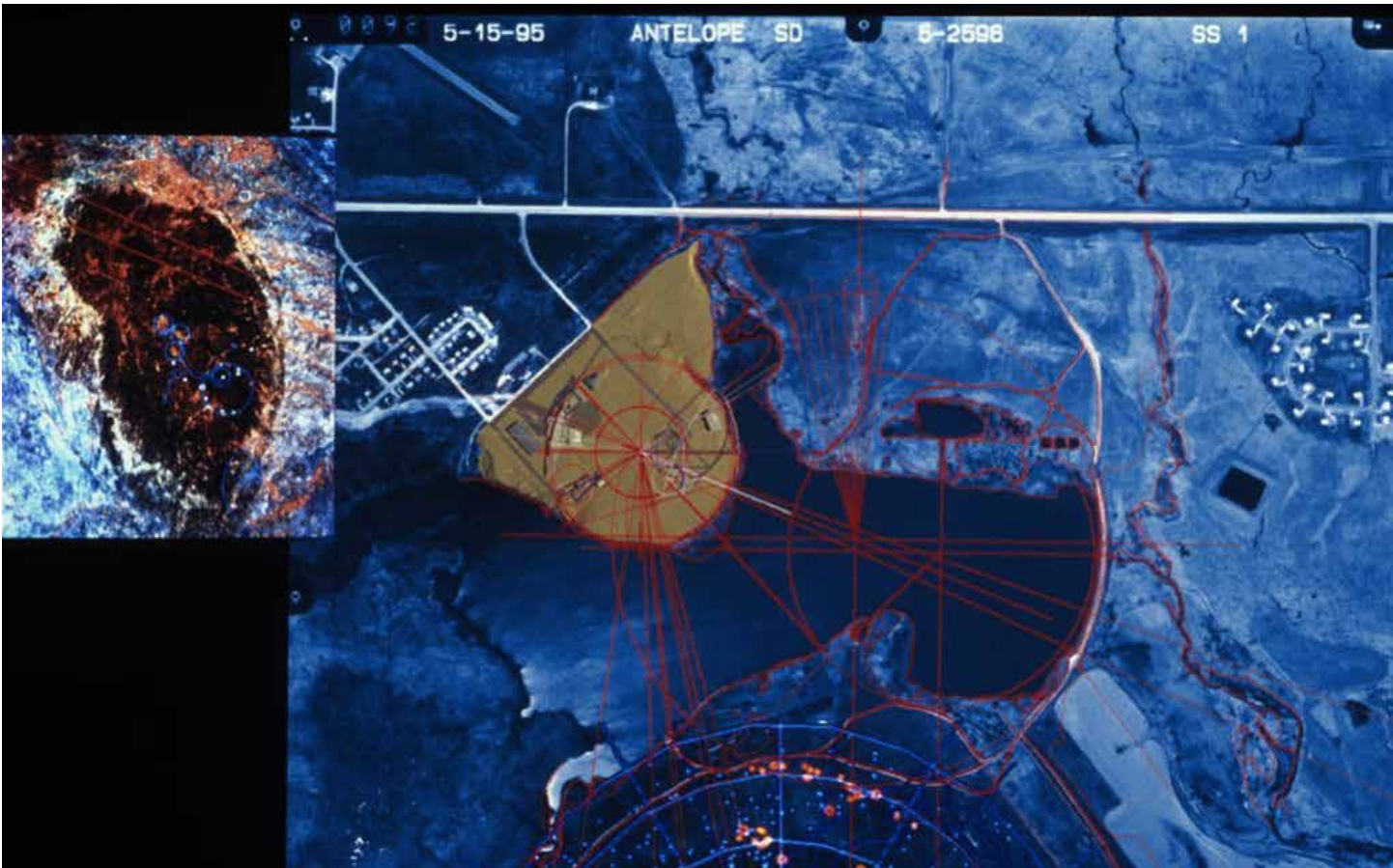



17 PRAIRIE VIEW A&M UNIVERSITY

PRAIRIE VIEW, TEXAS

The building is a gateway to the campus, serving as a landmark expressing the new growth of this historical school, one of the Historic African-American Universities. It is the new home of the College of Art and Architecture, the Cultural Center (research archives and museum of African-American History), Community Development, Construction Science, and an interdisciplinary satellite Business School to expand the curriculum. The creative, production, and delivery process for this project were used to teach students. Michael Rotondi was a faculty member for 3 years.

RELEVANCE/ ROLE OF FIRM	Education, environment as teacher, architectural design, interior design, consultant coordination, materials research, construction documents and administration
SCOPE OF WORK	Programming, master planning, site planning, architecture, community presentations
STATUS	Complete
SIZE	110,000 SF
CLIENT	Prairie View A&M University

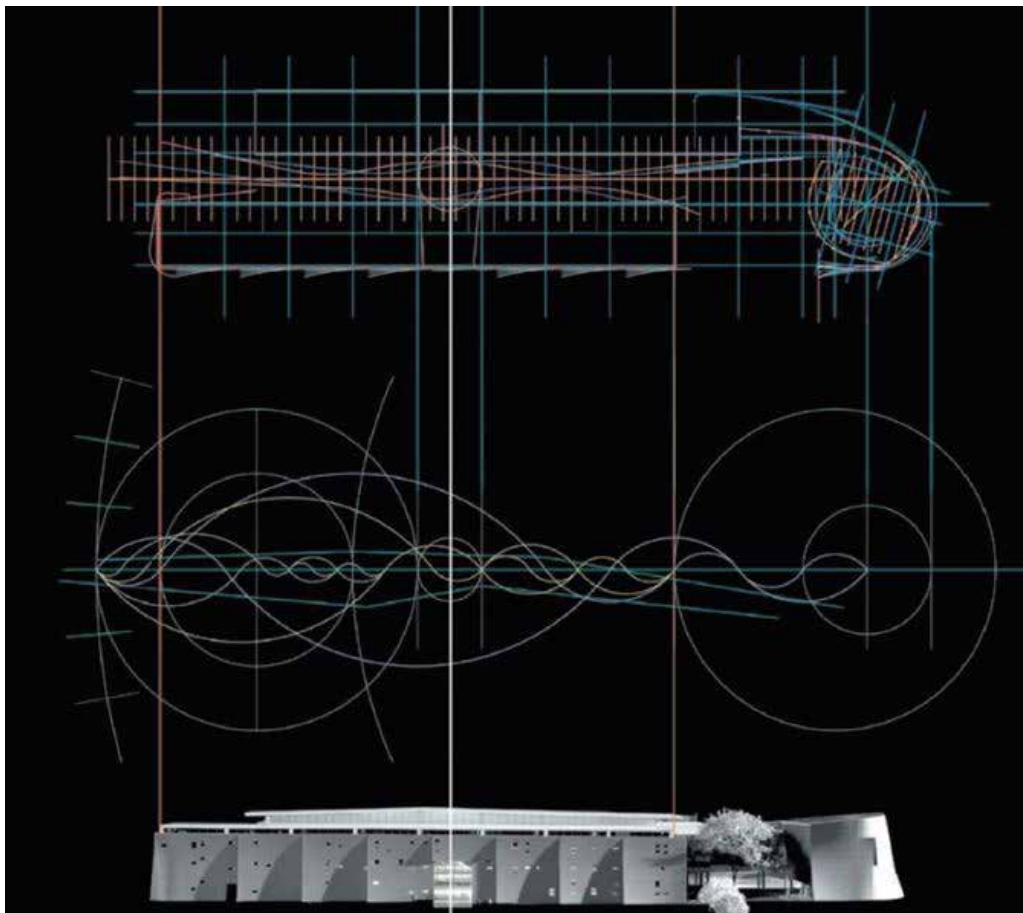



18 SOUTHERN CALIFORNIA INSTITUTE OF ARCHITECTURE

LOS ANGELES, CALIFORNIA

SCI-Arc is presented as an example of Prof. Michael Rotondi's experience in co-founding, conceiving, building, and leading an institution for higher education in Architecture.

The facilities were designed by SCI-Arc faculty. Prof. Michael Rotondi, a co-founder of SCI-Arc, has been a faculty member, program director, institute director, and is currently on the board of trustees. He has direct experience conceptualizing and developing all aspects of an educational institution. He was responsible as 2nd Director for leading the process of a regional school becoming an international presence with a positive influence. He has been a teacher, and administrator and an institution builder.

Prof. Michael Rotondi's long time, multi-faceted experience with SCI-Arc which, till this day, is still considered among the best, most experimental schools of architecture in the world, has given him the type of insight that is needed in working with higher education.

RELEVANCE Education, experimental learning, robotics, technology.

ROLE Co-Founder, Former Director, Distinguished Faculty

TYPE Institution





19 CHOCTAW COMMUNITY WELLNESS CENTER
CHOCTAW, MISSISSIPPI

From an architectural programming point of view, this project represents the cutting edge in wellness design. The Choctaw Community Wellness Center (CCWC) models a broad, holistic view of health and wellness by merging inter-connected programs which together support physical, educational, economic, cultural and spiritual well-being.

The Choctaw Community Wellness Center is home to a Design and Media Lab where youth, young adults and Elders can become creators of digital media. From games and apps to augmented and virtual reality, Choctaw people will have access to cutting-edge technology and a global network of pioneers and mentors. The resources available can be used to not only train Choctaw youth and develop their skills, but to give them tools to be the authors of their own methods to preserve and share their culture. The CCWC is also home to a pioneering Fab Lab. By combining local and regional manufacturing experience with open community access, CCWC FAB is an ideal environment for everything from education and workforce development to personalized community manufacturing.

RELEVANCE	Community center, cultural preservation & resilience, master planning, wellness, education, water reuse & recycling, technology lab, organic farming & research.
STATUS	Concept
SIZE	130,000 SF (Existing), 20,000 SF (Proposed)
CLIENT	Produced with Experimental Design for the Mississippi Band of Choctaw Indians





20 VOGT CREATIVE COMMONS

LOUISVILLE, KENTUCKY

A post-industrial common, and a community for the integrated creative workforce sector.

This existing 50 acres urban industrial site, at the geographical center of the metro-Louisville, will be transform into an active part of the city for the first time, socially, culturally and economically. A controlled access site will be completely permeable so the space of the city and its' citizens can filter through. It will become an incubator city, a post-industrial commons, and a community for the integrated creative development of the Arts, Sciences, and Humanities, co-inhabiting with artisan-craft manufacturing and botanical research and organic agrarian housing. Civic Leadership of Louisville, a city of approximately one million, has constructed over many years, the full range of Arts and Culture Facilities and programs equal to many first tier cities. What we discovered in our period of due diligence, there were no provisions for growing 'the next generation of Artists and Innovators.

RELEVANCE	Experimental community, economic development, public access performance spaces, master planning, water reuse & recycling, modular building, organic farming & research.
STATUS	Concept
SIZE	50 Acres, 2 M SF Land, 1 M SF Existing Building, 1.5 M SF Existing and New Building
CLIENT	Vogt Commons Ltd. University of Louisville, University of Kentucky

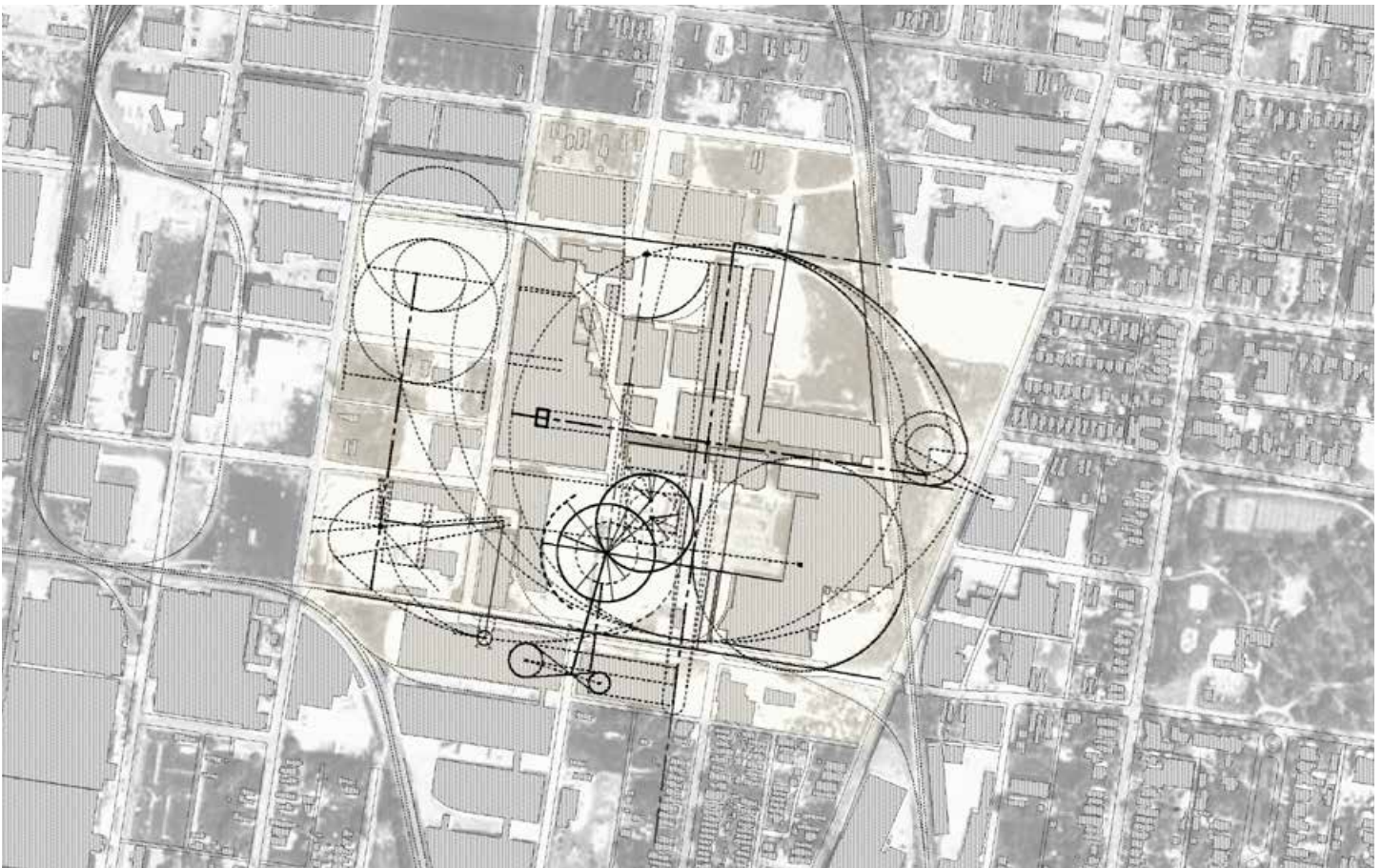



ORDERING PRINCIPLES

MALIBU RESIDENCE

MALIBU, CALIFORNIA



HEIFEI CULTURAL CENTER
HEIFEI, CHINA

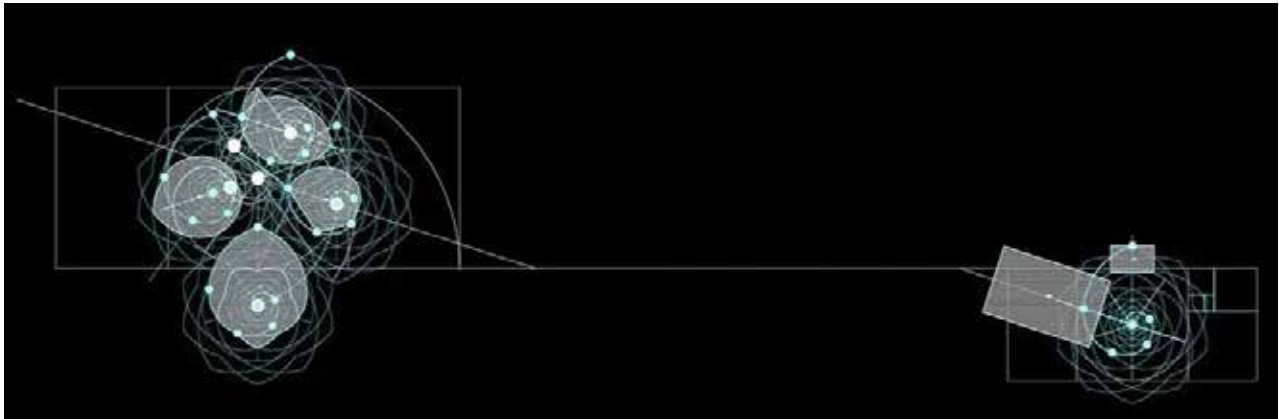
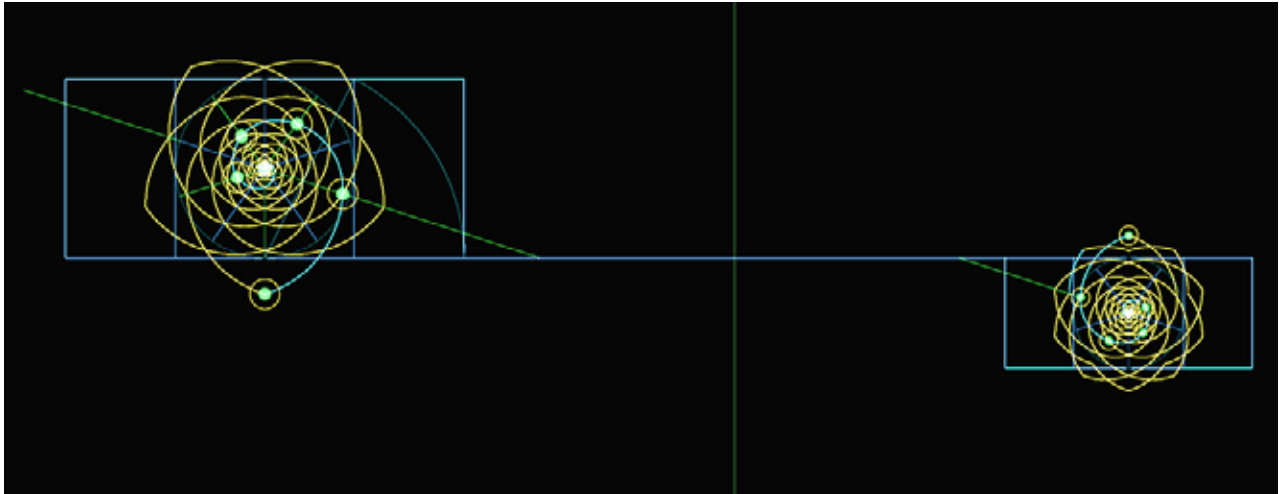
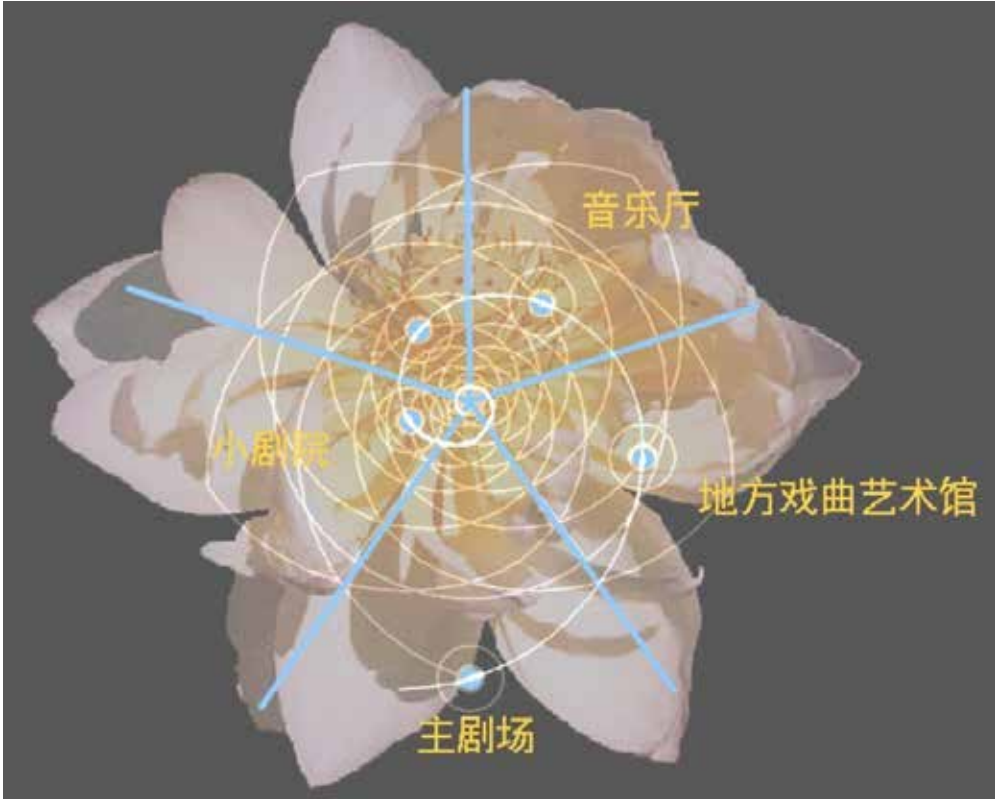

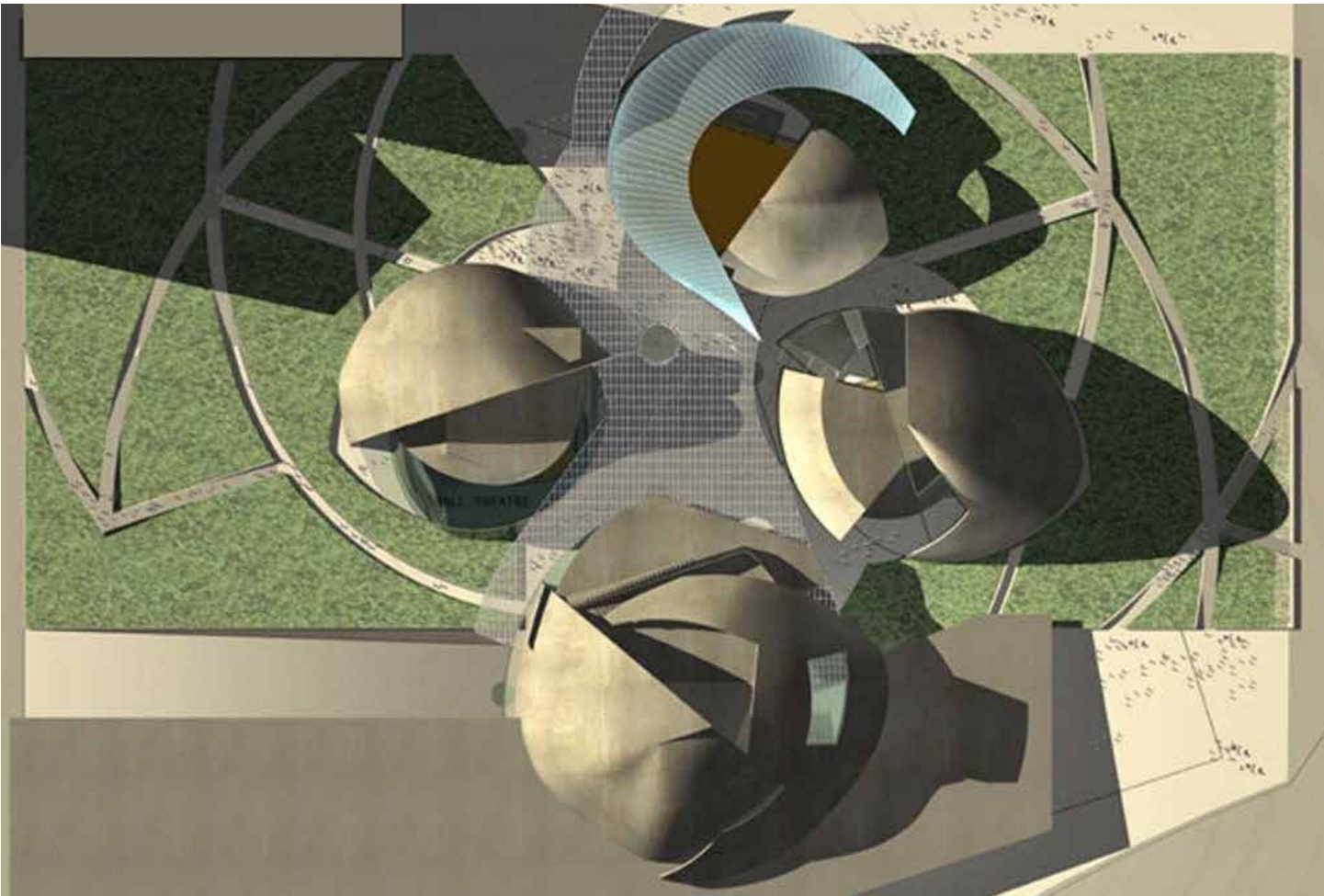

100,000 STUPAS
SOQUEL, CA

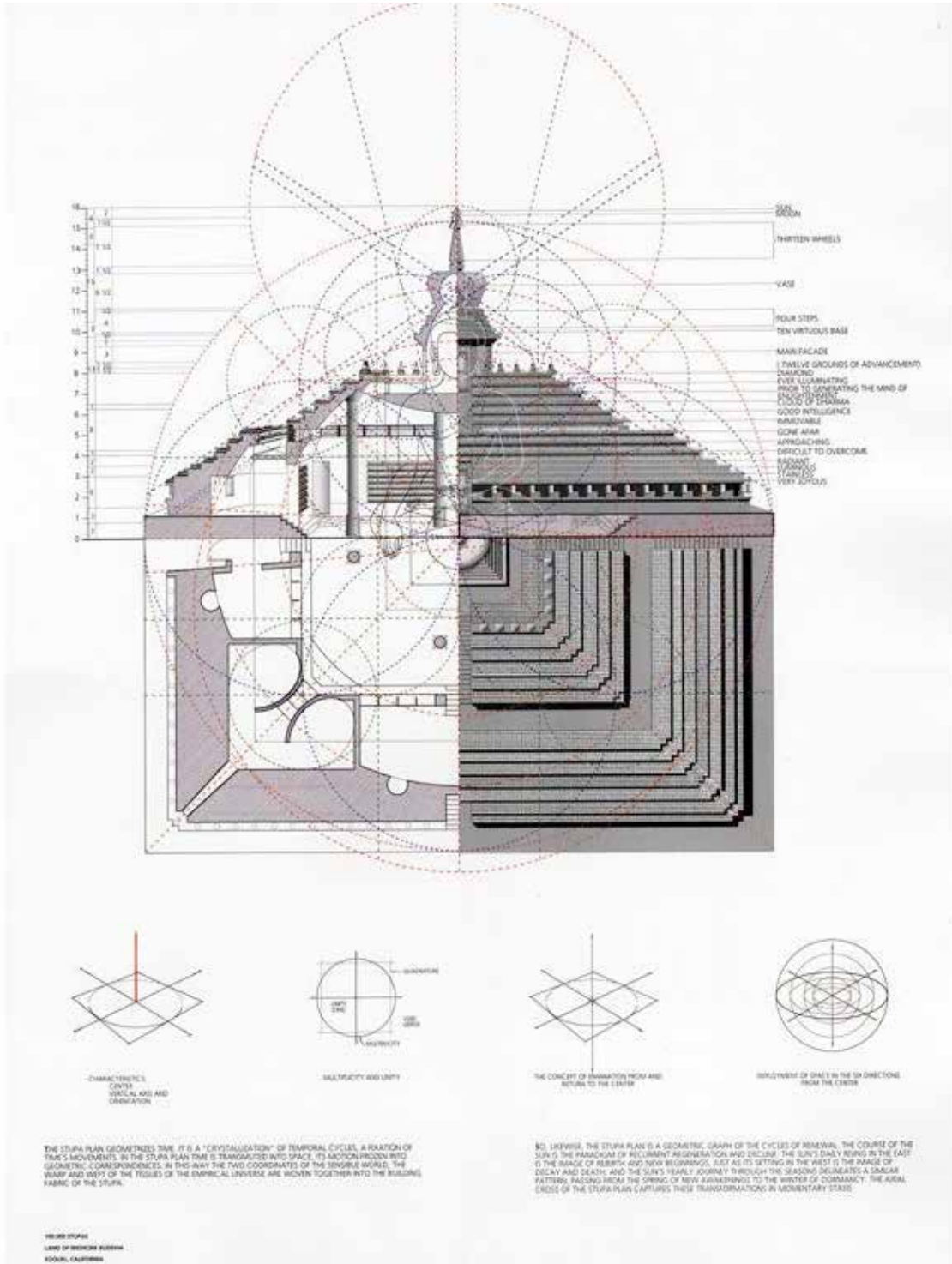

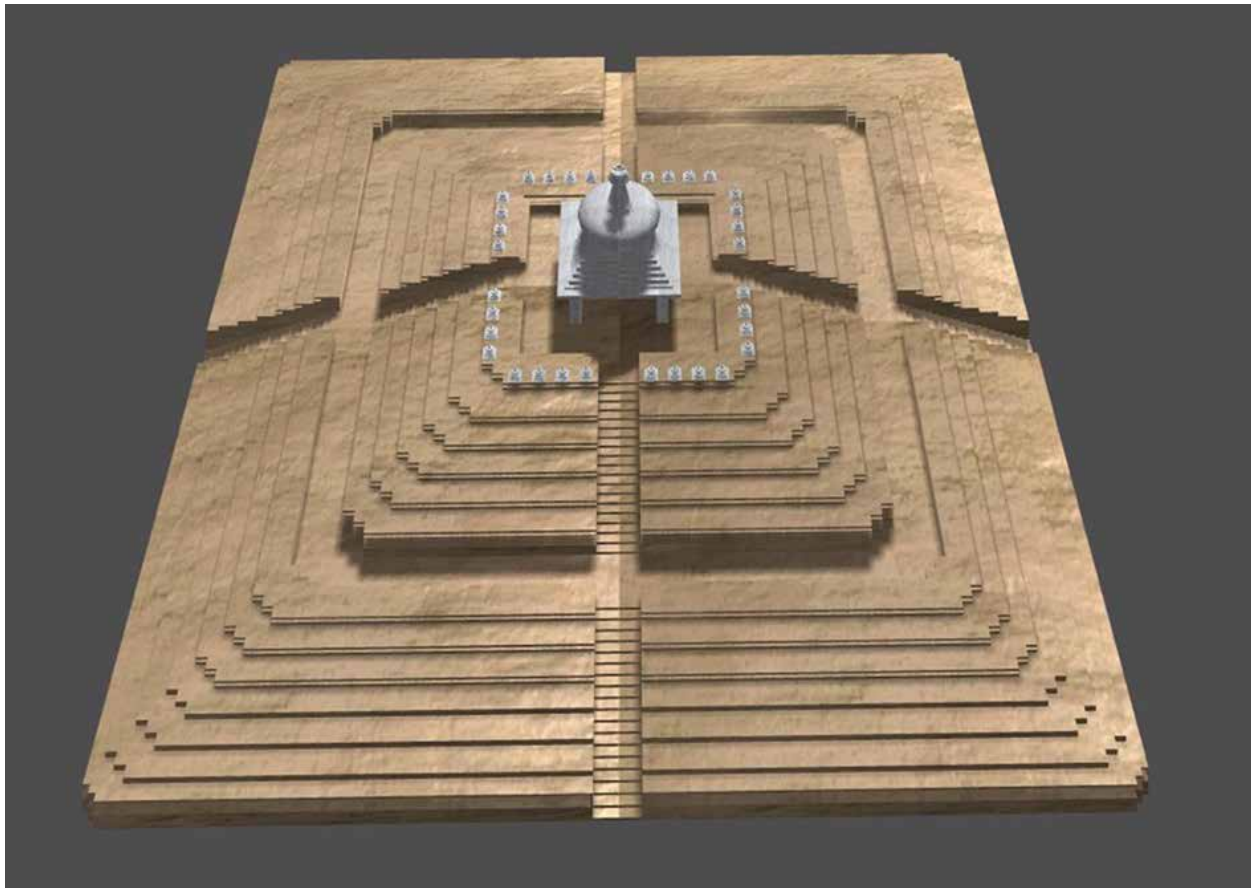

ZANGDOK PALRI
TEHACHAPI, CA



ARI BHOD AERIAL



- ENTRANCE GATE
- NEW PARKING LOT (100 SPACES)
- NEW PART OF MAIN BUILDING
- STAGE
- STAY HOUSE
- NEW WOOD HOUSE
- LAKE'S STICKS CAMP
- APPROVED STAGE

- EXISTING TOWNSHIP
- WATER ELECTRIC SYSTEM
- WOODEN CAMP
- NEW CAMP
- EXISTING STAY HOUSE
- STAY HOUSE

- LEGEND
- NEW BUILDING
 - EXISTING BUILDING
 - NEW PARKING
 - NEW ROAD
 - NEW ROADWAY
 - NEW ROADWAY
 - NEW ROADWAY

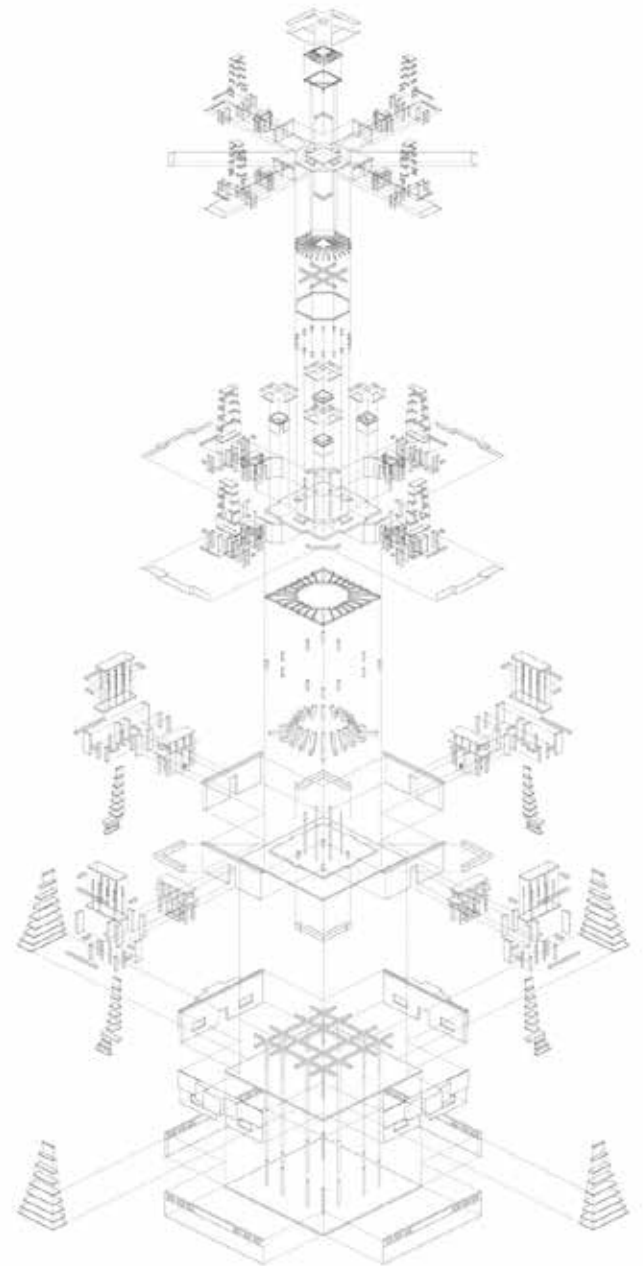
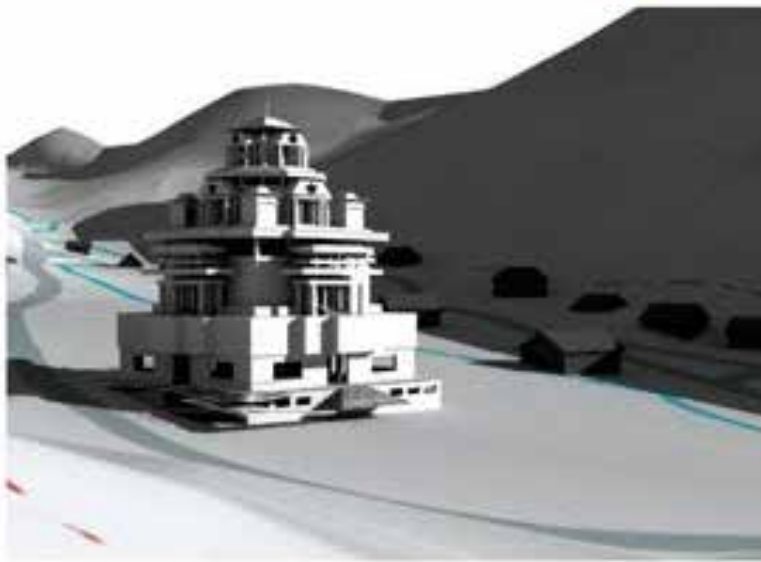
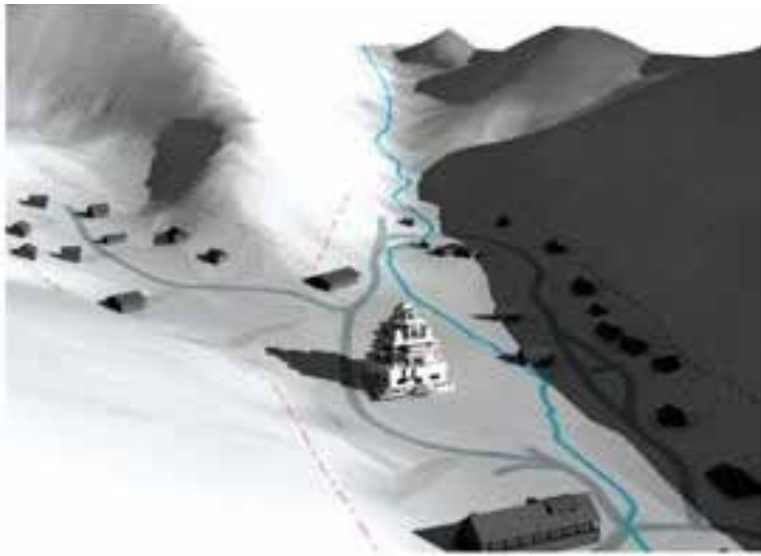

ZANGDOK PALRI MANDALA - EXPLODED AXONOMETRIC

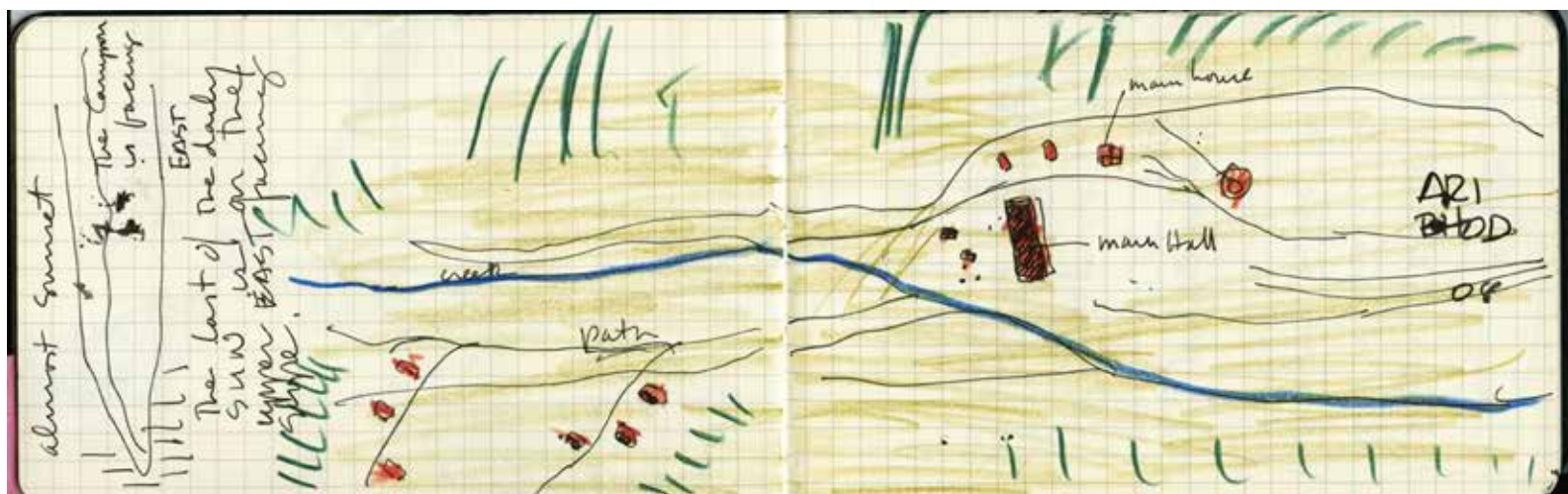

SINTE GLESKA UNIVERSITY
ROSEBUD SIOUX, SOUTH DAKOTA

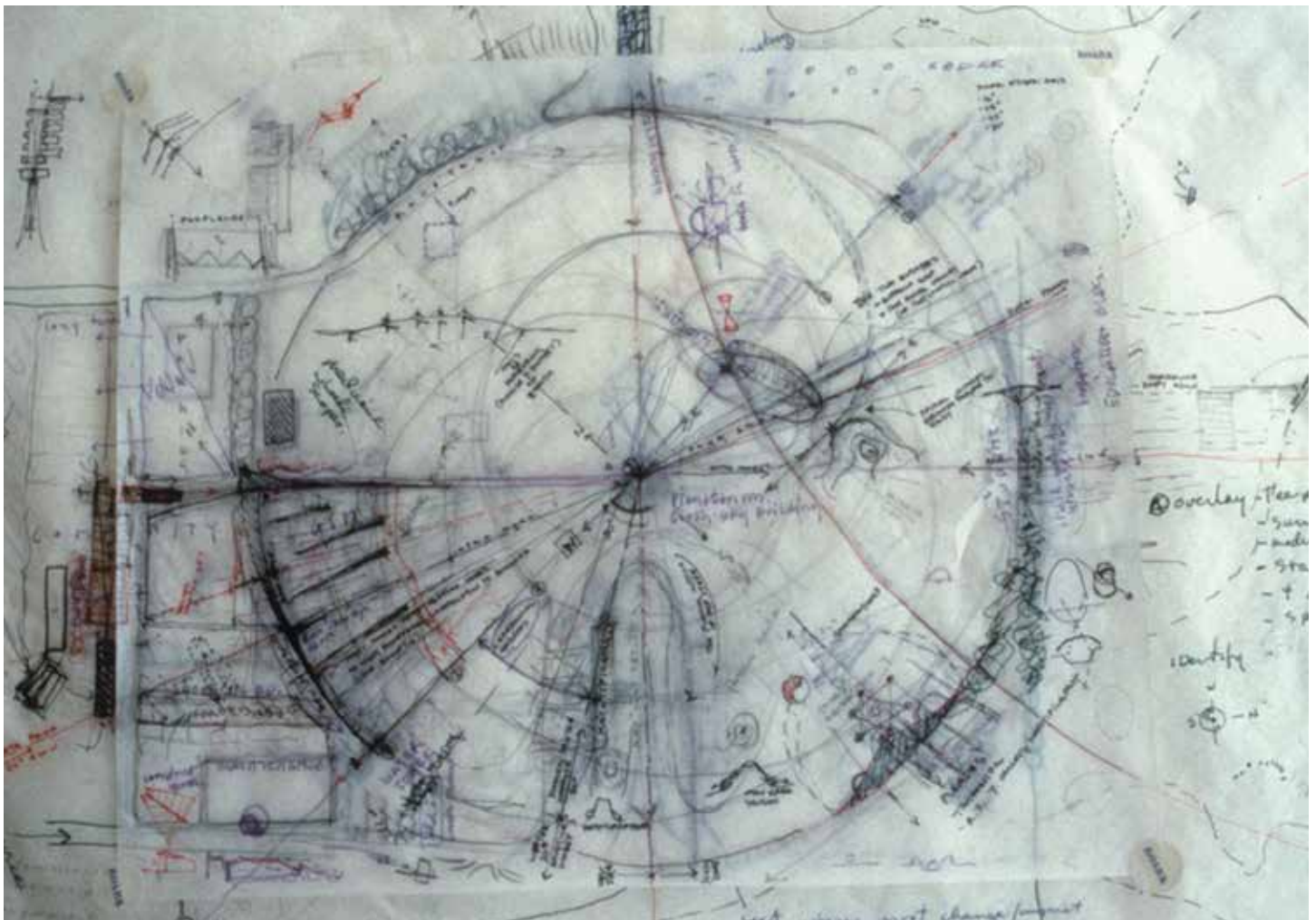
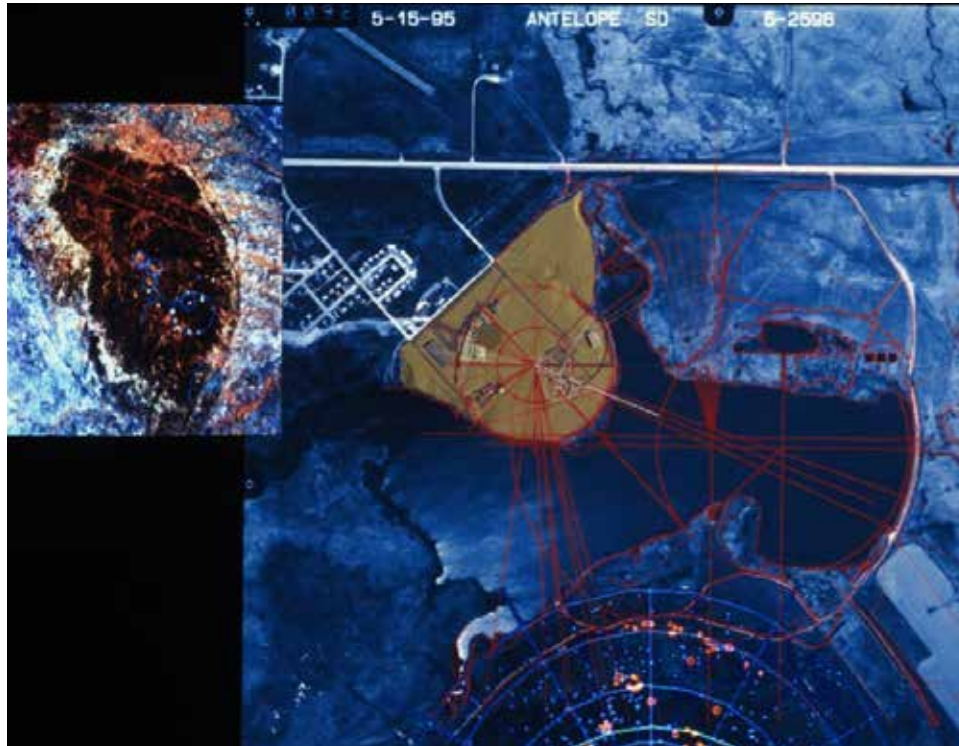

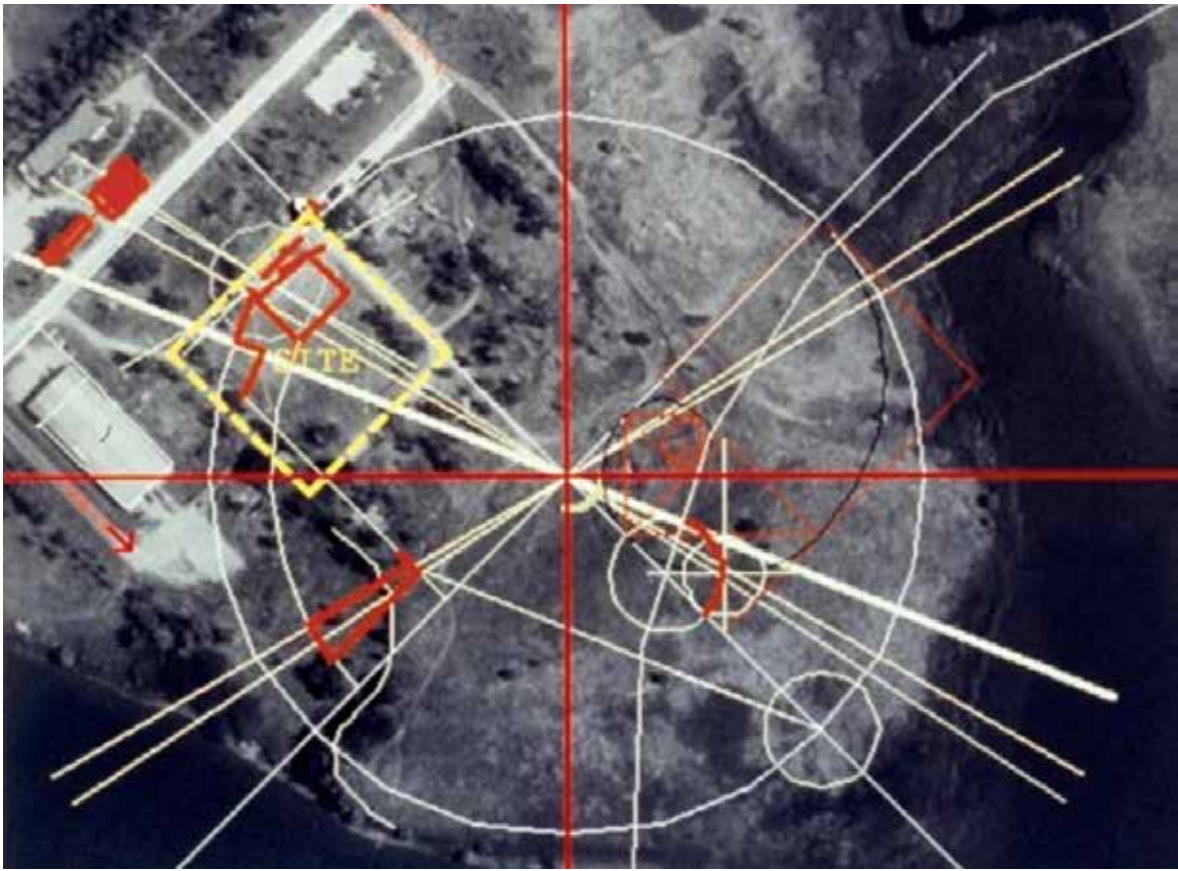

SINTE GLESKA UNIVERSITY contd.

ROSEBUD SIOUX, SOUTH DAKOTA

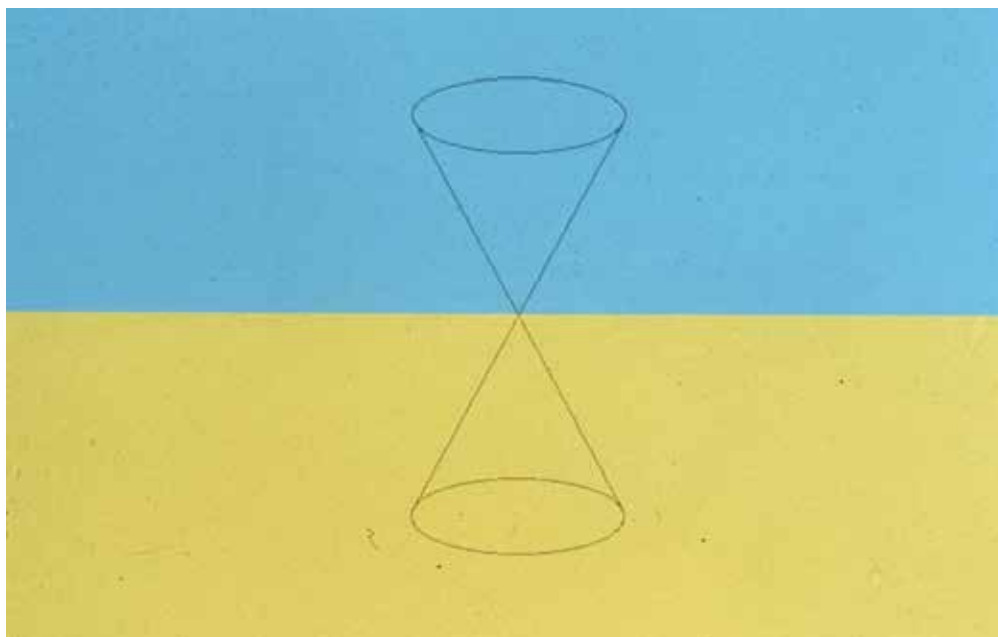

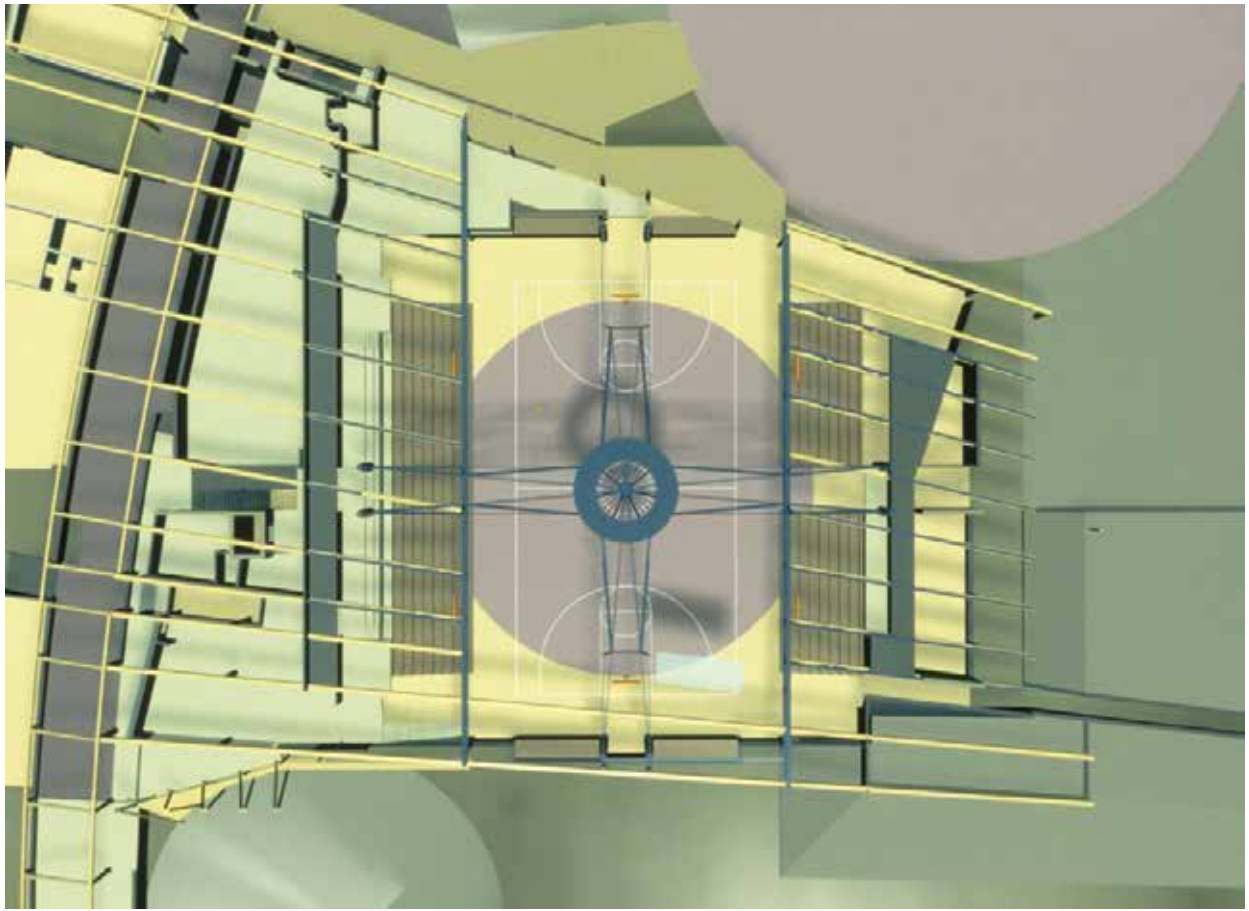

JPGA GOLF COURSE, CHIBA

KANTO, JAPAN

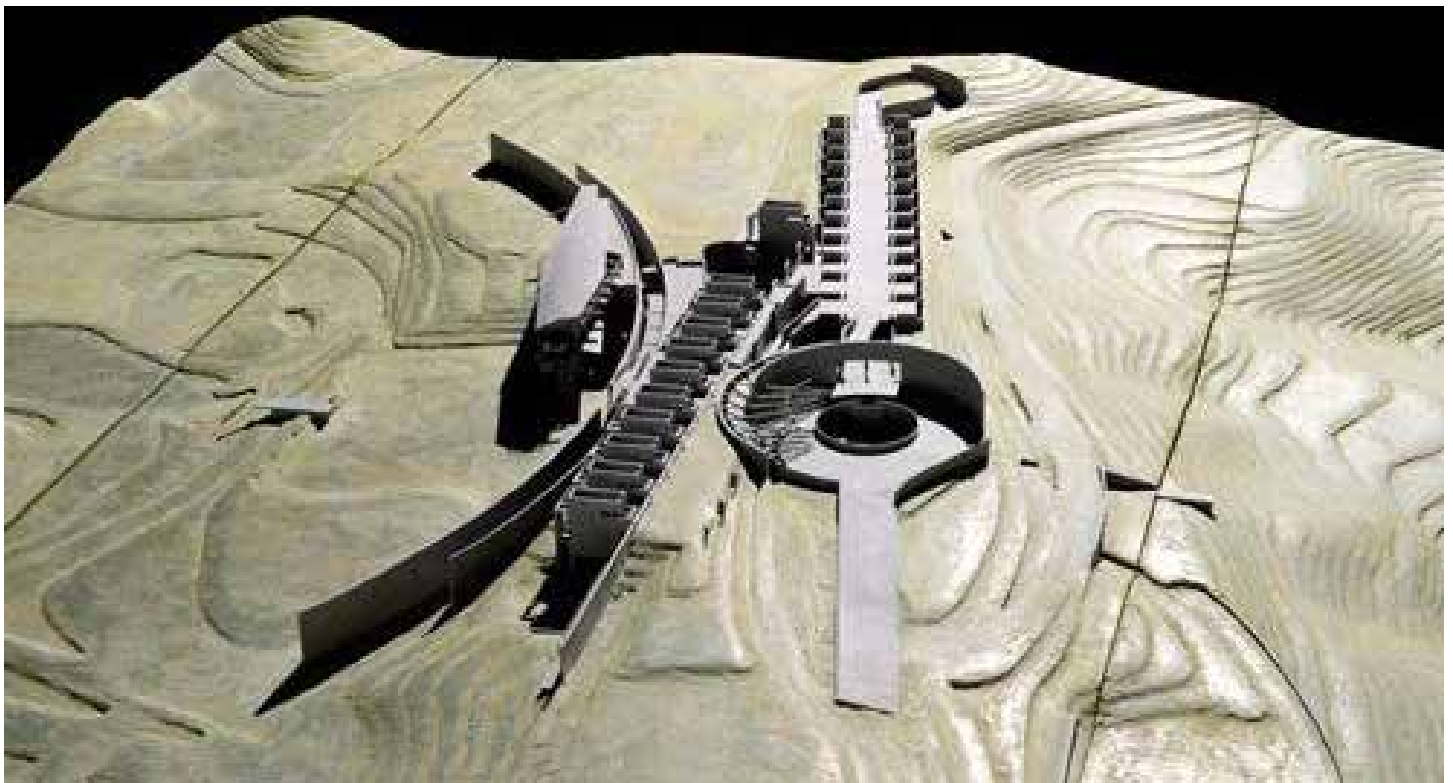
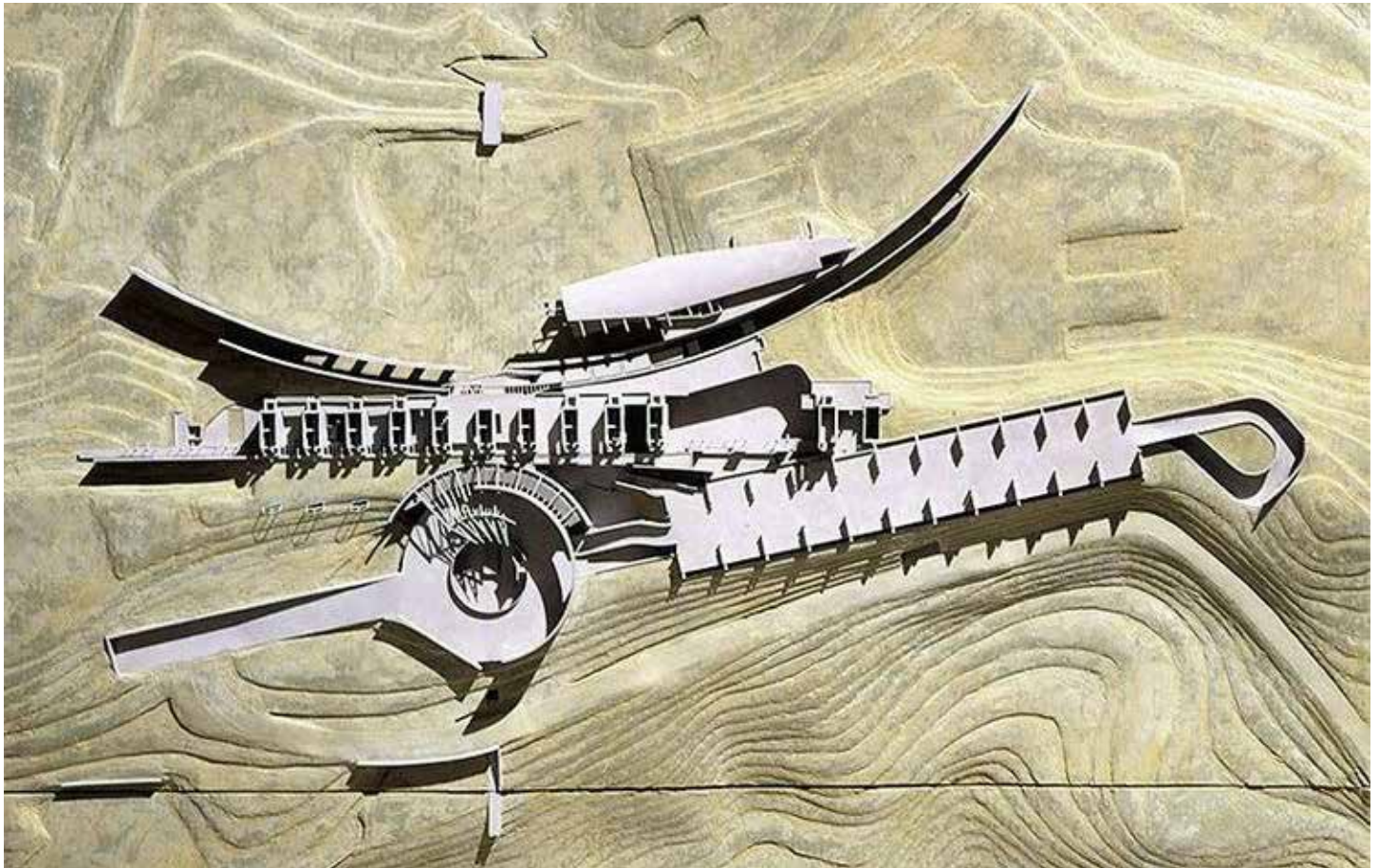

SKETCHES

BY MICHAEL ROTONDI

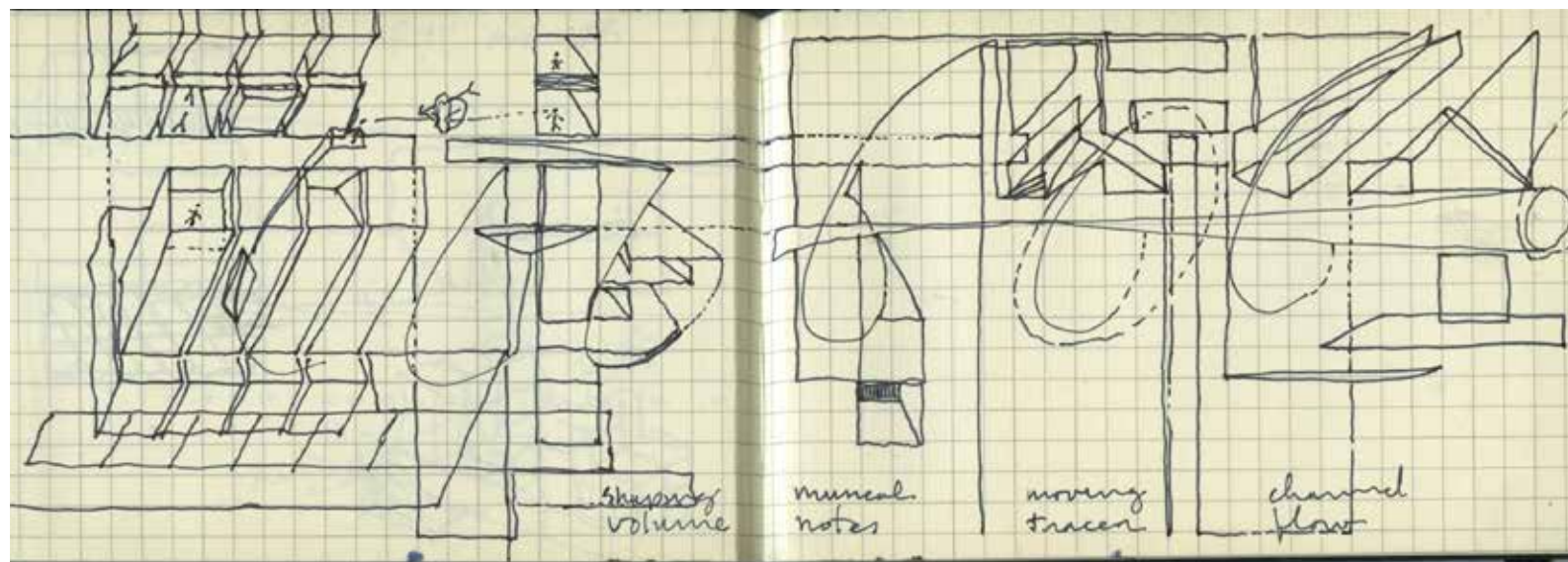
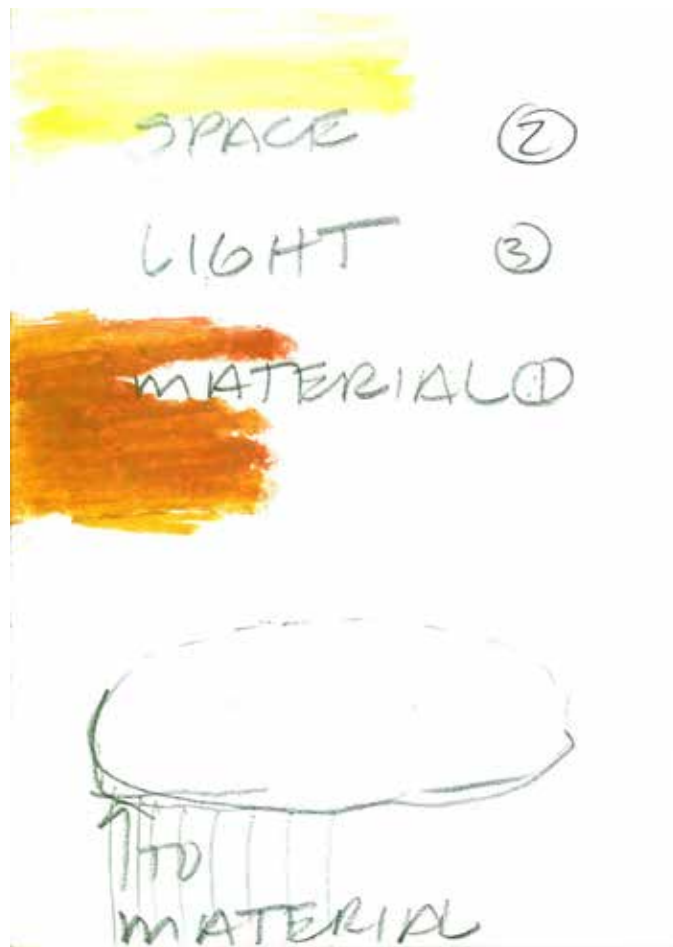

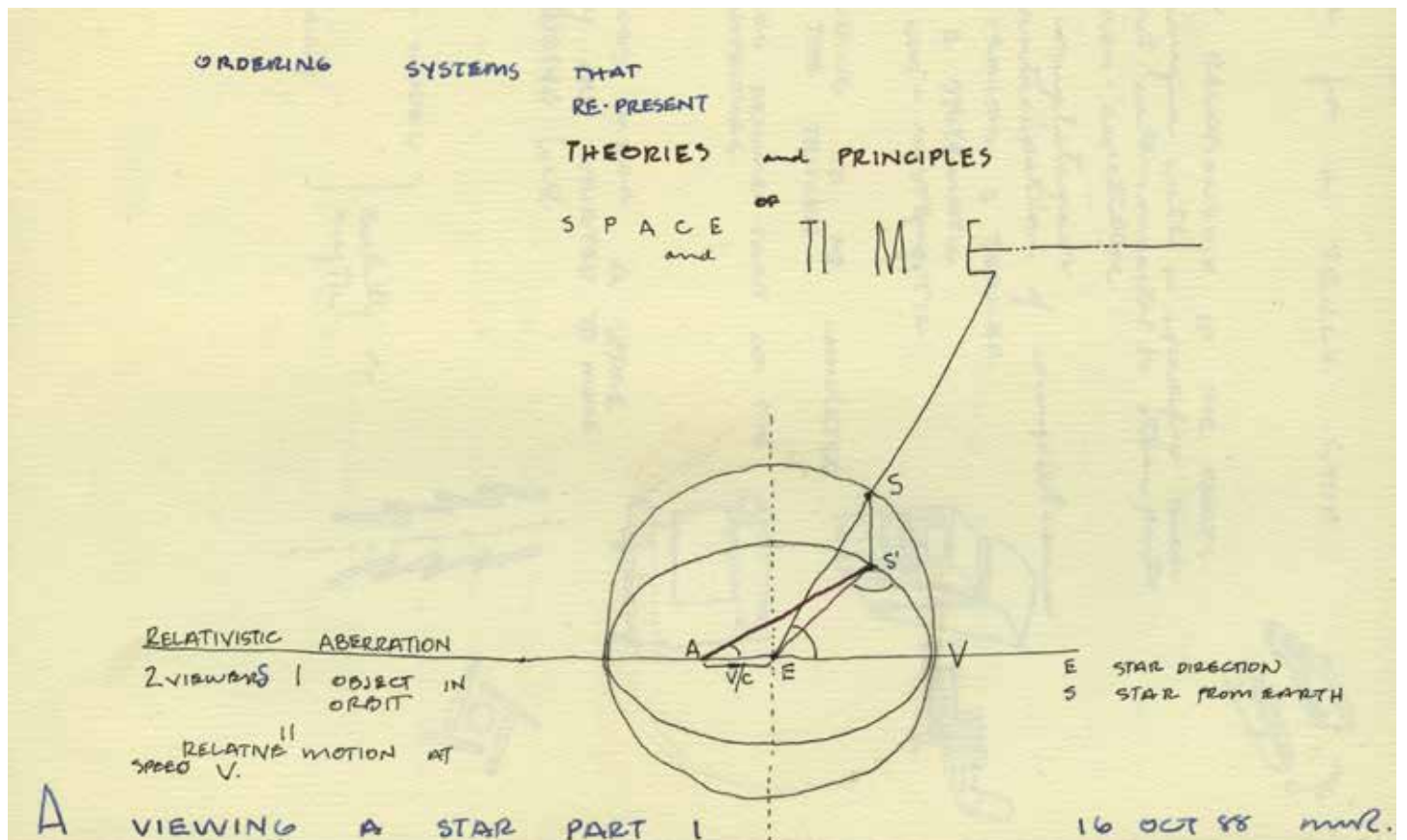
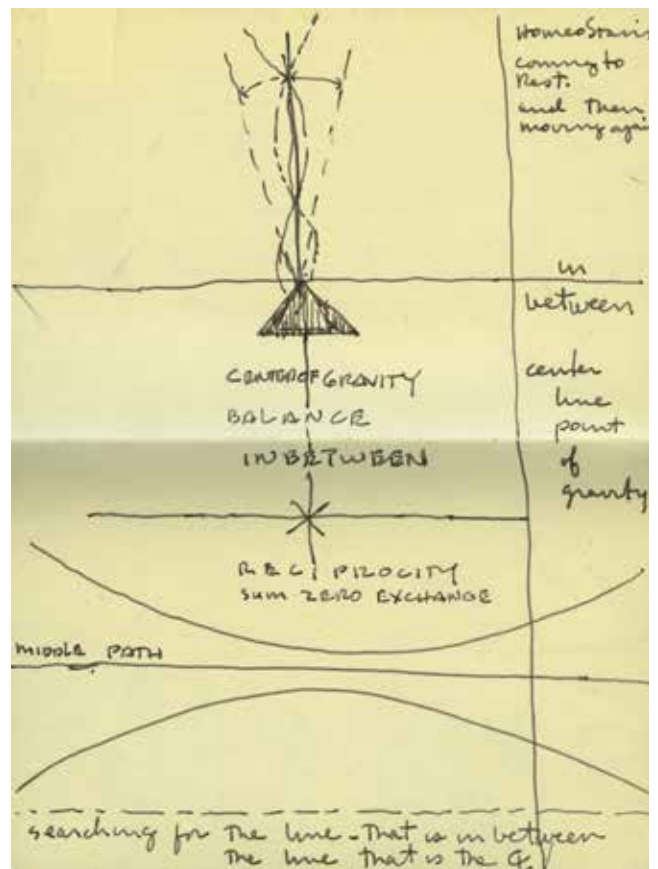
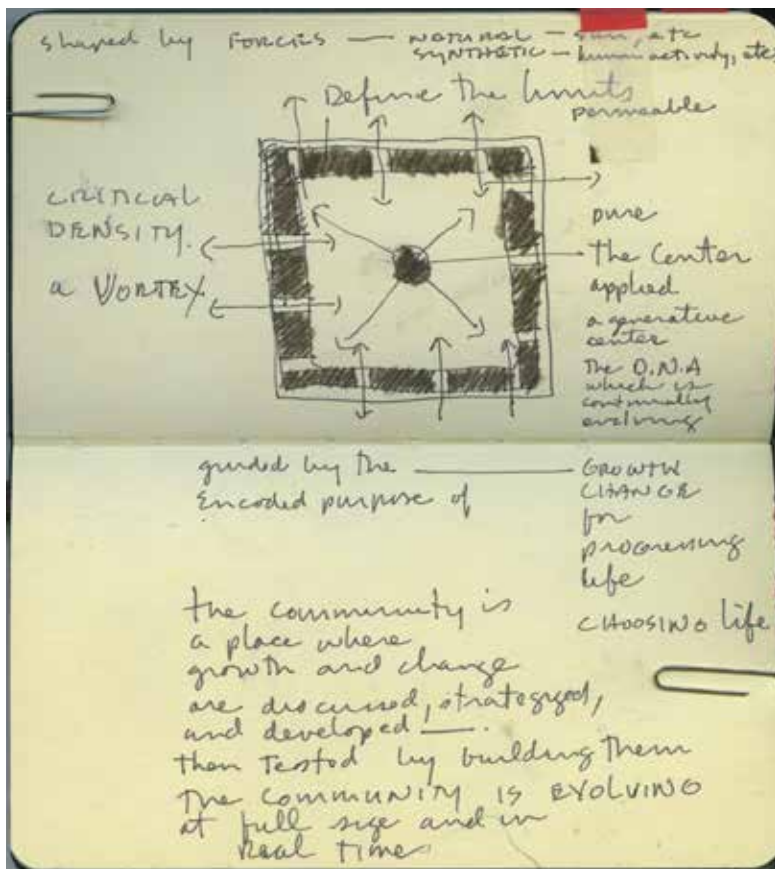

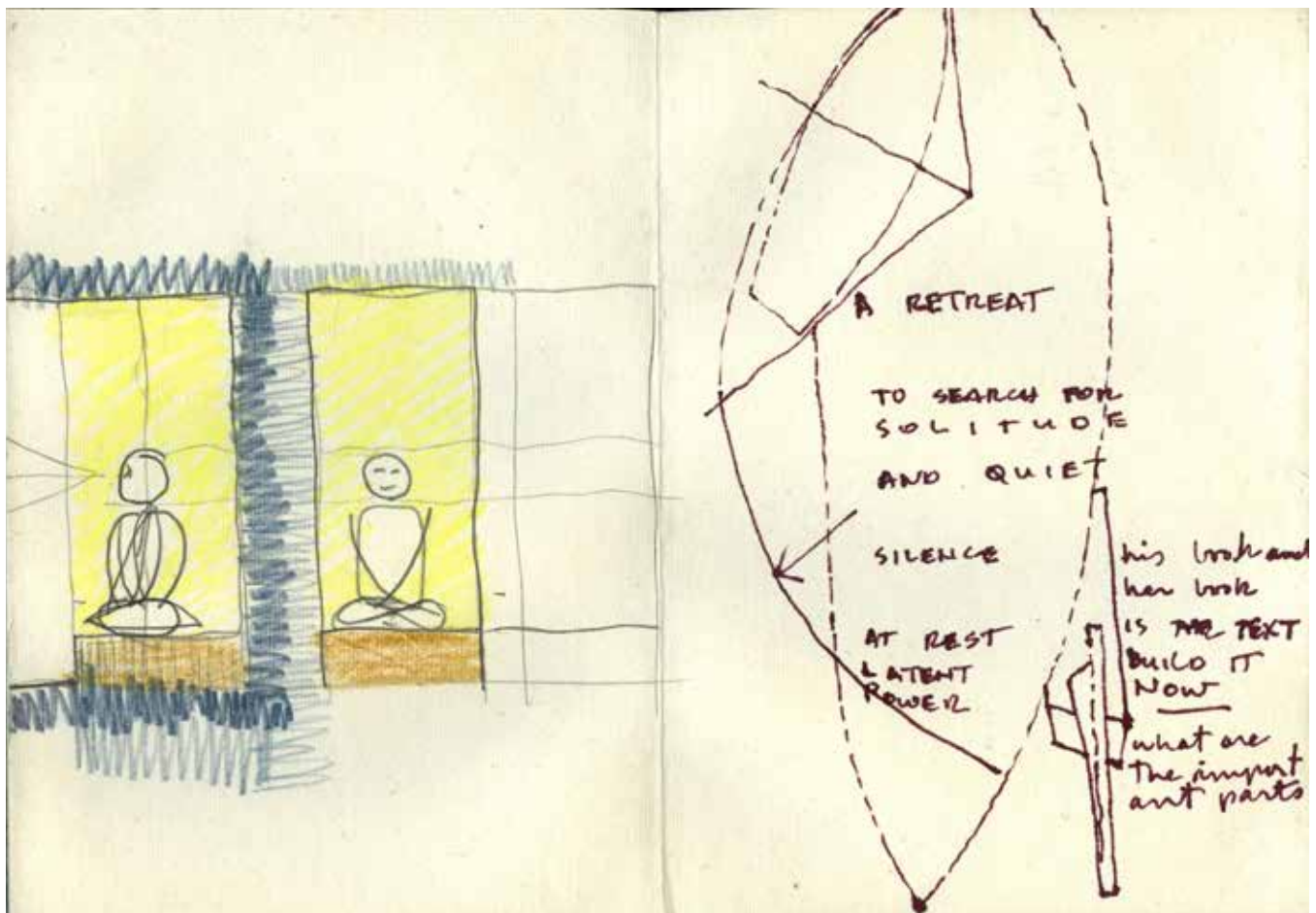
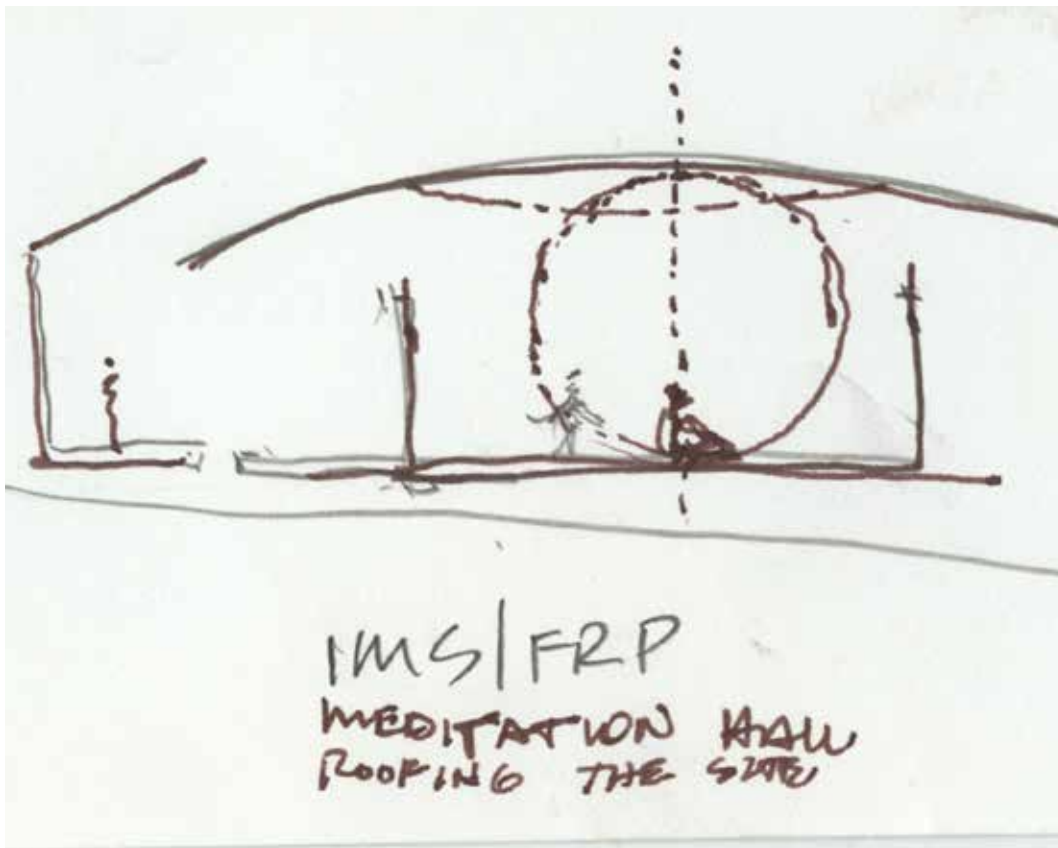

SELECTED HONORS & AWARDS

2014	The 2014 Richard Neutra Award for Professional Excellence College of Environmental Design / Department of Architecture, California State Polytechnic University Pomona	1998	AIACC Design Award Warehouse C
			AIACC Design Award Teiger House
2013	Design Intelligence 2013 30 Most Admired Design Teachers in America		AIACC Excellence in Education Achievement Award
2010	Los Angeles Business Council Architectural Award for Retail Madame Tussauds	1997	FAIA - College of Fellows inducted for Design and Education
	Hollywood Arts Council Architectural Arts Charlie Award Madame Tussauds	1996	American Wood Council's Design Award Nicola Restaurant
			AIALA Award, Honor Award Carlson-Reges Residence
2009	Southern California Development Forum (SCDF) Award for design Madame Tussauds		Progressive Architecture Award Sinte Gleska University
	AIA/LA Award, Gold Medal Award		AIACC Award Carlson-Reges Residence
2008	Los Angeles Business Council, Community Impact Award CD7 Neighborhood City Hall	1995	AIACC Award Dorland Mountain Arts Colony
2007	AIACC Design Award Prairie View A&M University		Sunset Magazine Honor Award Carlson-Reges Residence
	AIA Los Angeles Twenty-Five Year Award 2-4-6-8 House		LA Business Council Urban Award Nicola Restaurant
2005	AIALA Award Prairie View A&M University		Los Angeles Architectural Foundation Award
	AIALA Award CD7 Neighborhood City Hall	1994	AIACC Award, Honor Award Nicola Restaurant
	Concrete Masonry Design Awards Merit Award UCSD La Jolla Playhouse		AIA Certificate of Appreciation
		1993	Progressive Architecture Award Citation Circolo Restaurant
2002	AIACC Award View Silo House	1992	American Academy of Arts & Letters Award in Architecture
	Wood Design Award View Silo House		Progressive Architecture Award CDLT 1, 2 House Addition
1999	AIA National Design Award Carlson-Reges Residence	1991	AIACC Award Salick Health Care Corporate Headquarters

1991	Progressive Architecture Award Yuzen Vintage Car Museum	Progressive Architecture Award Kate Mantilini
1990	AIACC Award Politix Retail Stores	Progressive Architecture Award Prototypical Restaurant
	Interior Award Leon Max Showroom	1986 AIALA Award Angeli Restaurant
	AIACC Award Leon Max Showroom	National AIA Award, Honor Award Bergren Residence
	Progressive Architecture Award Arts Park Performing Pavilion	AIACC Award 72 Market Street
	Progressive Architecture Award Higashi Azabu Tower	1985 AIALA Award, Merit Award 72 Market Street
1989	AIACC Award Cedars-Sinai Comprehensive Cancer Center	AIALA Award, Merit Award Lawrence Residence
	Progressive Architecture Award Arts Park Performing Arts Pavilion	AIALA Award, Merit Award Bergren Residence
	Progressive Architecture Award Crawford Residence	1985 Progressive Architecture Award Venice III House
	Progressive Architecture Award Higashi Azabu Tower	1984 Progressive Architecture Award Hermosa Beach Commercial Center
1988	AIALA Award Cedars-Sinai Comprehensive Cancer Center	1982 Progressive Architecture Award Western-Melrose Office Building
	AIACC Award Kate Mantilini Restaurant	1981 AIALA Award Sedlak House
	National AIA Award, Honor Award Kate Mantilini Restaurant	1980 Progressive Architecture Award Flores Residence
	Progressive Architecture Award 6th Street Residence	1977 Competition Honor Award Sacramento Energy Efficient Office Building
1987	AIALA Award, Honor Award 6th Street Residence	Progressive Architecture Award Riedel Medical Building
	AIALA Award Kate Mantilini Restaurant	1974 Progressive Architecture Award Sequoyah Educational Research Center
	Progressive Architecture Award Cedars-Sinai Comprehensive Cancer Center	